

MODULAR LABORATORY & OFFICE FURNITURE





This catalogue is made for general information purposes only.
Dimensions have to be considered merely indicative. Finished products colours may differ from the ones reproduced on this catalogue because of the printing process. Due to the constant development of our products, we reserve the right to apply changes to both specifications and design, or to remove models at any time, without warning obligation.
Please contact our sales department before ordering.



Sr. No.	Product Detail	Specification	Price
1	Computer Table- COF-1	Size:- Length: 900mm, Width:600mm, Height: 750mm. C-Frame & Tubular cold rolled close annealed Steel Structure. Fabrication involves only MIG/TIG & Spot welding .Top & shelf made of 18mm thick pre-laminated particle board. PVC Edge beading of 2mm edges by Through Feed Machine. Shelf adjustable on steel brackets. Removable tubular CPU stand and an embossed modesty panel below table top provided. Provision for wire management. Drum Type Leveller. All steel components are epoxy powder coated after seven tanks anti corrosion treatment of surface. The overall appearance of the product shall be as per photograph.	P.O.R
2	Computer Table- COF-2	Size:- Length: 800mm, Width:430mm, Height: 750mm. Frame Structure made of 18mm thick Pre-laminated Particle Board. Key board made of Pre-laminated Particle Board 18mm thick on telescopic channel slide. Casters for Mobility. Design as per photograph, Available in wide range of shades.	P.O.R
3	Computer Table- COF-3	Size:- Length: 1300mm, Width:600mm, Height: 750mm C- Frame & Tubular cold rolled close annealed Steel Structure. Fabrication involves only MIG/TIG & Spot welding .Top & shelf made of 18mm thick pre-laminated particle board. Edge beading of edges by Through Feed Machine. Shelf adjustable on steel brackets. Removable tubular CPU stand and an embossed modesty panel below table top provided. Provision for wire management. Drum Type Leveler. Fitted with 3 drawer storage box (W 350mm D 575mm H 430mm). All steel components are epoxy powder coated after seven tanks anti corrosion treatment of surface. The overall appearance of the product shall be as per photograph.	P.O.R
4	Computer table- COF-4	Size: Length:- 900mm, Width:-450mm, Height:-750 mm. C-Frame & tubular cold rolled close annealed steel structure. Fabrication involves only MIG/TIG & Spot welding. Top made of 18mm thick Pre-laminated Particle Board. PVC Edge beading of 2mm thick by Through Feed Machine. Electrical Cable Tray made of 0.6mm thk MS cold rolled close annealed sheet press formed 3 fold 115mm ht. Provision to run cable in legs. Drum Type Leveller. Metal keyboard tray and removable CPU stand. All steel components are epoxy powder coated after seven tanks anti corrosion treatment of surface. The overall appearance of the product shall be as per photograph.	P.O.R
5	Computer table-add-on unit. COF-5	Size: Length:- 900mm, Width:-450mm, Height:-750 mm. C-Frame & tubular cold rolled close annealed steel structure. Fabrication involves only MIG/TIG & Spot welding .Top made of 18mm thick Pre-laminated Particle Board. PVC Edge beading of 2mm thick by through Feed Machine. Electrical Cable Tray made of 0.6mm thk MS cold rolled close annealed sheet press formed 3 fold 115mm ht. Provision to run cable in legs. Drum Type Leveller. Metal keyboard tray and removable CPU stand. All steel components are epoxy powder coated after seven tanks anti corrosion treatment of surface. The overall appearance of the product shall be as per photograph. Note: Add on table can be used with main table only.	P.O.R
6	Corner Table COF-6	Size: Length:- 1050mm, Width:-1050mm, Height:-760 mm. C-Frame & tubular cold rolled close annealed steel structure. Fabrication involves only MIG/TIG & Spot welding .Top made of 18mm thick PLPB. PVC Edge beading of 2mm thick by Through Feed Machine. Electrical Cable Tray made of 0.6mm thk MS cold rolled close annealed sheet press formed 3 fold 150mm ht. Provision to run cable in legs. Drum Type Leveller. Metal keyboard tray and removable CPU stand. All steel components are epoxy powder coated after seven tanks anti corrosion treatment of surface. The overall appearance of the product shall be as per photograph	P.O.R
7	Keyboard Tray COF-7	Size:- Width:490mm, Depth:245 mm..(Size without telescopic channel) Made up of prime quality MS cold rolled close annealed sheet of 0.8mm thk. Fitted with branded telescopic channel, Top hanging brackets are provided. All steel components are epoxy powder coated after seven tanks anti corrosion treatment of surface. Overall appearance shall be as shown in picture.	P.O.R

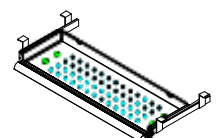

Sr. No.	Product Detail	Specification	Price
8	CPU Trolley COF-8	Size: - Length: 245mm Width: 250-300mm, High: 220mm. Made of press formed MS cold rolled close annealed sheet 1.6mm thk. The width is adjustable from 150mm to 275mm. Rubber Pads are pasted inside the trolley for better grip and twin wheel nylon rollers provided for mobility. All steel components are epoxy powder coated after seven tanks anti corrosion treatment of surface. The overall appearance of the product shall be as per photograph.	P.O.R
9	CPU Stand- Leg Inbuilt COF-9	Made of 18mm Pre-laminated Particle Board supported by 20mmX20mmX18G Square CR Tube. All steel components are epoxy powder coated after seven tanks anti corrosion treatment of surface. The overall appearance of the product shall be as per photograph.	P.O.R
10	OFFICE TABLE -T-900 COF-10	Size:- Length:900mm, Width: 600mm, Height 750mm C- Frame & Tubular cold rolled close annealed Steel Structure. Fabrication involves only MIG/TIG & Spot welding .Top made of 18mm thick pre-laminated particle board. PVC Edge beading of 2mm thick by Through Feed Machine. Dotted embossed steel modesty panel at visitor's side and with single drawer (W-350mm, H-165mm D-475mm) with branded telescopic channel. Provided with Drum Type Leveller. All steel components are epoxy powder coated after seven tanks anti corrosion treatment of surface. The overall appearance of the product shall be as per photograph.	P.O.R
11	OFFICE TABLE- T-1200 COF-11	Size:- Length:1200mm, Width: 600mm, Height 750mm C- Frame & Tubular cold rolled close annealed Steel Structure. Fabrication involves only MIG/TIG & Spot welding .Top made of 18mm thick pre-laminated particle board. Edge beading of edges by Through Feed Machine. Dotted embossed steel modesty panel at visitor's side and with three drawers (W-350mm, H-430mm D-575mm) with branded roller. Provided with Drum Type Leveller... All steel components are epoxy powder coated after seven tanks anti corrosion treatment of surface. The overall appearance of the product shall be as per photograph.	P.O.R
12	OFFICE TABLE- T-1500 COF-12	Size:- Length:1500mm, Width: 750mm, Height: 750mm C- Frame & Tubular cold rolled close annealed Steel Structure. Fabrication involves only MIG/TIG & Spot welding .Top made of 18mm thick pre-laminated particle board. PVC Edge beading of 2mm thick by Through Feed Machine. Dotted embossed steel modesty panel on visitor's side and with three drawer (W-350mm, H-430mm D-575mm) with branded telescopic channel. Provided with Drum Type Leveller.. All steel components are epoxy powder coated after seven tanks anti corrosion treatment of surface. The overall appearance of the product shall be as per photograph.	P.O.R
13	OFFICE TABLE -ET-1200 COF-13	Size:- Length:1200mm, Width: 600mm, Height: 750mm C- Frame Leg 200mm wide made of aluminium profile and cold rolled close annealed formed sections, having provision for wire management. Top made of 25mm thick Pre-laminated Particle Board. PVC Edge beading of 2mm thick by Through Feed Machine. Dotted embossed cable Duct and Perforated steel modesty panel on visitor's side .All steel components are epoxy powder coated after seven tanks anti corrosion treatment of surface. The overall appearance of the product shall be as per photograph.	P.O.R
14	OFFICE TABLE -T-1200DX-16-A COF-14	Table of size 1200Wx600Dx750H(mm) Top made up of 18mm pre-laminated particle board duly sealed with 2mm thick PVC beading on all sides. Under structure made up of top frame with cold rolled close annealed MS sheet of 0.9mm thick. Tubular frame of MS ERW round tube of Dia 25mmx1.2mm thick, Storage made up of single drawer unit with 0.8mm thick cold rolled close annealed MS sheet of overall size 350Wx575Dx430H(mm). Colours Available: Silver Grey and Teak. All steel components are epoxy powder coated after seven tanks anti corrosion treatment of surface. The overall appearance of the product shall be as per photograph.	P.O. R

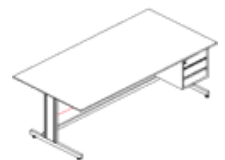

Sr. No.	Product Detail	Specification	Price
15	OFFICE TABLE-ET-1350 COF-15	Size:- Length:1350mm, Width: 600mm, Height: 750mm, C- Frame Leg 200mm wide made of aluminium profile and cold rolled close annealed formed sections, having provision for wire management. Top made of 25mm thick Pre-laminated Particle Board. PVC Edge beading of 2mm thick by Through Feed Machine. Dotted embossed cable Duct and Perforated steel modesty panel on visitor's side .All steel components are epoxy powder coated after seven tanks anti corrosion treatment of surface. The overall appearance of the product shall be as per photograph.	P.O.R
16	OFFICE TABLE ET-DX1500 COF-16	Overall size 1500Wx750Dx750H (mm). Table top made up of 18mm thick pre laminated particle board with 2mm thick lipping on the edges. Under structure made up of MSERW square tube of size 30x30x1.2 (mm) thick. Side, front, back panel made up of 18mm prelaminated particle board. Table includes pedestal made up of combination of prelaminated panel and MS sheet. Overall size 450Wx750Dx525H(mm). All steel components are epoxy powder coated after seven tanks anti corrosion treatment of surface. The overall appearance of the product shall be as per photograph	P.O.R
17	OFFICE TABLE ET-1365 COF-17	Table of size 1365Wx680Dx750H(mm) Top made up of 18mm prelaminated particle board duly sealed with 2mm thick PVC beading on all sides. Under structure made up of top frame with cold rolled close annealed MS sheet of 0.9mm thick, tubular frame of MS ERW round tube of Dia 25mmx1.2mm thick. Storage made up 0.8mm thick cold rolled close annealed MS sheet with one drawer unit of overall size 350Wx575Dx430H(mm) in three drawer. On other side the size of drawer in two compartment 350Wx575Dx430H (mm). All steel components are epoxy powder coated after seven tanks anti corrosion treatment of surface. The overall appearance of the product shall be as per photograph.	P.O.R
18	OFFICE TABLE ET-1500 COF-18	Size:- Length:1500mm, Width:750mm, Height: 750mm, C- Frame Leg 200mm wide made of aluminum profile and cold rolled close annealed formed sections, having provision for wire management. Top made of 25mm thick Pre-laminated Particle Board. Edge beading of edges by Through Feed Machine. Dotted embossed cable Duct and Perforated steel modesty panel on visitor's side .All steel components are epoxy powder coated after seven tanks anti corrosion treatment of surface. The overall appearance of the product shall be as per photograph.	P.O.R
19	OFFICE TABLE ET-1800 COF-19	Size:- Length:1800mm, Width: 900mm, Height: 750mm, C- Frame Leg 200mm wide made of aluminium profile and cold rolled close annealed formed sections, having provision for wire management. Top made of 25mm thick Pre-laminated Particle Board. Edge beading of edges by Through Feed Machine. Dotted embossed cable Duct and Perforated steel modesty panel on visitor's side .All steel components are epoxy powder coated after seven tanks anti corrosion treatment of surface. The overall appearance of the product shall be as per photograph.	P.O.R



Sr. No.	Product Detail	Specification	Price
20	Executive Suite Table- ET-3000 COF-20-	Overall size 3000mm x 1200mm x750mm with top made of 25mm PLPB and 12mm thick corian top & edges of the table shall also with corian. The table shall have 2 former module supported on steel vertical post of 65mm Dia X 1.6mm duly powder coated. The main table shall have understructure having verticals made of 36mm thick particle board post formed legs supported with 32mm dia. steel studs duly powder coated and modesty made of 18mm thick particle board having decorative laminate on both sides. Footrest shall be made out of 18mm plywood frame work with 6mm top and shall be finished with 0.6mm thick laminate. Side unit- Side Unit having overall size 1310x500x750mm, - Made of 25 mm PLPB with 12 mm thick corian top & edges of the table also with corian. Side unit shall have understructure having verticals made of 12mm thick post formed and made of 18mm thick pre laminated particle board having decorative laminate. The side unit shall have a provision for keyboard operable space for CPU and a printer shelf and an open able shutter in 18mm PLPB as per Drawing. Back Unit- Back Unit having overall size 3000 mm x500mmx750mm with top made of 25 mm PLPB with 12mm thick corian top & edges	P.O.R



		of the table also with corian. Storage unit of size 2500x500x750mm shall have understructure having verticals made of 18mm thick pre laminated particle with 2 operable shutter storage and drawer fascia in PLPB 18mm thick vertical legs and glass as in drawing.	
--	--	---------------------------------------------------------------------------------------------------------------------------------------------------------------------------------------------------------------------------------------------------------------------	--

Sr. No.	Product Detail	Specification	Price
21	Executive Suite Table -ET-2100, Senio Executive Table Type-I COF-21	Overall Size : Table - Lenght-2100mm x Width-900mm x Height-750mm, Side runner -Width-1200mm x Depth-450mm x Height-750mm, Back Runner- Width-1650mm x Depth-450mm x Height-750mm, Corner unit - Lenght-450mm x Width-450mm x Height-750mm, 3Drawer Pedestal size- Width-450mm x Depth-540mm x Height-650mm, Table- made of BWR ply wood laminated with good quality mm thk laminate fitted with 25mm thick MDF fascia duly deco painted. Door & drawer front made of 18 mm thk BSLPB. Top of desk and cabinet made of 12mm thk clear float glass. Product must be in compliance with drawing and as per architect instruction Complete product must be knockdown type in construction.	P.O.R

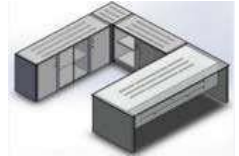

Sr. No.	Product Detail	Specification	Price
22	Angular Table With Side Unit Type-II COF-22	ANGULAR TABLE WITH SIDE UNIT, MF-71, Size: Width-2700mm x Depth-1050mm x Height- 750mm. The table shall be made of 25mm MDF board with 0,6mm thick laminate post form with edge effect of 36mm. The angular section shall be membrane coated or PU painted. The main table shall have under structure having verticals made of 25mm thick particle board post formed Legs with modesty made of 25mm thick" particle board having decorative laminate on both sides. The table shall have a drawer, unit of size 460x575x550 mm having two drawers and one filing. The drawer unit shall be made of thick pre-laminated particle board with post formed facia. Side Unit - The overall size of side unit shall be 1800 x 550 x 750mm. Top made of 25mm thick MDF board with 0.6mm laminated post formed on it. The under structure shall be made of 25mm thick particle board having decorative laminate on both side. The side unit shall have open able shutter storage and 3 drawer units with facia duly post formed. Table top and side unit shall have glass top of 12mm thickness duly bevelled. Levellers to be provided at Bonton. The overall appearance of the product shall be as per photograph.	P.O.R



Sr. No.	Product Detail	Specification	Price
23	MD's Table with side runner with drawer pedestal Executive Suite Table ET-1800 COF-23-	Overall table size: W 1800mm x D 900mm x H 750mm, Top made of 36mm thick BSL particle board and short sides duly seated with PVC edge beading of 2mm thickness. Base made of 36mm thick BSL particle board with levellers. Top supporting rail of 25mm thick BSL particle board. side runner of size W 1000mm x D 400mm x H 634mm. made of 18mm thick BSL Particle board and top 36mm BSL particle board. Side runner shall have one cupboard. Pedestal with three drawers shall be provided of 450mm width. Overall appearance of the item shall be as per the photograph.	P.O.R



Sr. No.	Product Detail	Specification	Price
24	Executive Table ET-1800 COF-24	Overall Size:- Table - Lenght-1800mm x Width-900mm x Height-750mm, Side runner - Width-900mm x Depth-400mm x Height-750mm, Back Runner-Width-1165mm x Depth-400mm x Height-750mm, Comer unit- Lenght-635mm x Width-635mm x Height-750mm, Table and side runner made of pre laminated particle board and post form particle board as per design requirement. All tops 25mm thick and sides made of 18mm thick pre laminated particle board. Table must be made as per drawing and architects approval	P.O.R

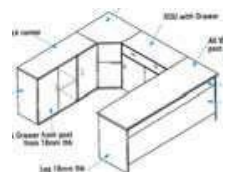

Sr. No.	Product Detail	Specification	Price
25	Executive Table - ET-1665 COF-25	Overall size of table 1665Wx900Dx750H (mm). Table top made up of 18mm thick pre-laminated board with 2mm thick lipping on the edges. ERU of size 900Wx450Dx720H (mm) made up of 18mm thick pre-laminated board top with 2mm thick lipping on all sides. Under structure made up of MSERW square tube of size 30x30x1.2 (mm) thick. Side, front, back panel made up of 18mm pre-laminated twin board. Table includes pedestal made up of PLPB of size 450Wx700Dx530H (mm).	P.O.R



Sr. No.	Product Detail	Specification	Price
26	Table 1350X600 with Key board tray COF-26	Table -Size: - Length: 1350mm, Width: 600mm, Height: 750mm, Top made of 25 mm thick PLPB. Cable duct made of 0.8 mm CRCA sheet, Aluminum Section 60X40 with 8 mm Leveller with 25 mm PLPB. Front panel made of 18 mm thick PLPB. Key Board Tray-Size:- Width:490mm, Depth:245 mm.,(Size without telescopic channel) Made up of prime quality MS cold rolled close annealed sheet of 0.8mm thk. Fitted with branded telescopic channel, Top hanging brackets are provided. All steel components are epoxy powder coated after seven tanks anti corrosion treatment of surface	P.O.R



Sr. No.	Product Detail	Specification	Price
27	Table 1500X750 with Key board tray COF-27	Size: - Length:1500mm, Width: 750mm, Height: 750mm, Top made of 25 mm thick PLPB. Cable duct made of 0.8 mm CRCA sheet, Aluminum Section 60X40 with 8 mm Leveller with 25 mm PLPB. Front panel made of 18 mm thick PLPB. Key Board Tray-Size:- Width:490mm, Depth:245 mm.,(Size without telescopic channel) Made up of prime quality MS cold rolled close annealed sheet of 0.8mm thk. Fitted with branded telescopic channel, Top hanging brackets are provided. All steel components are epoxy powder coated after seven tanks anti corrosion treatment of surface	P.O.R



Sr. No.	Product Detail	Specification	Price
28	Round table 1200mm dia COF-28	Diameter 1200mm height: 750mm Top made of 25 thk and base structure in Plus shape made of 18mm .thk pre-laminated particle board. All edges covered with pvc edge beading. Fitted with floor levellers at bottom. OR Frame made of 1.2 mm thk M.S. cold rolled close annealed tube duly Powder Coated/ Chrome plated. Fitted with 25mm Pre-laminated Particle Board top or Glass Top - 12mm thick.	P.O.R



Sr. No.	Product Detail	Specification	Price
29	Round table 900mm dia COF-29	Diameter 900mm height: 750mm Top made of 25 thk and base structure in Plus shape made of 18mm .thk pre-laminated particle board. All edges covered with PVC edge beading. Fitted with floor levellers at bottom. OR Frame made of 1.2 mm thk M.S. cold rolled close annealed tube duly Powder Coated/ Chrome plated. Fitted with 25mm Pre-laminated Particle Board top or Glass Top - 12mm thick.	P.O.R



Sr. No.	Product Detail	Specification	Price
30	Round table 750mm dia COF-30	Diameter 750mm height: 750mm Top made of 25 thk and base structure in Plus shape made of 18mm .thk pre-laminated particle board. All edges covered with pvc edge beading. Fitted with floor levellers at bottom. OR Frame made of 1.2 mm thk M.S. cold rolled close annealed tube duly Powder Coated/ Chrome plated. fitted with 25mm Pre-laminated Particle Board top or Glass Top - 12mm thick.	P.O.R



Sr. No.	Product Detail	Specification	Price
31	TABLE- 800- COF-31	Size Length 1000mm x width 800mm x Height 750mm C- Frame Leg made by aluminum profile and cold rolled close annealed formed sections, having provision for wire management. Top made of 25mm thick Pre-laminated Particle Board. Side Edges covered with PVC edge band on through feed edge bending machine. Dotted embossed cable Duct and Perforated steel modesty panel at visitor's side. All steel components are epoxy powder coated after seven tanks anti corrosion treatment of surface. The overall appearance of the product shall be as per photograph.	P.O.R



Sr. No.	Product Detail	Specification	Price
32	CORNER TOP-600 COF-32	Size: - Length: 600mm, Width: 600mm, Height: 750mm, Frame-Tubular cold rolled close annealed Steel Structure. Use only MIG/TIG & Spot welding for fabrication. Top made of Pre-laminated Particle Board. Side Edges covered with PVC edge band by through feed edge bending machine. All steel components are epoxy powder coated after seven tanks anti corrosion treatment of surface. The overall appearance of the product shall be as per photograph.	P.O.R

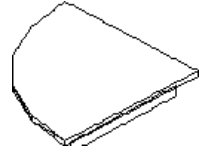

Sr. No.	Product Detail	Specification	Price
33	CHR-1350 COF-33	Size:- Length:1350mm, Width: 675mm, Height: 750mm, 200mm wide, C- Frame Leg made by aluminium profile and cold rolled close annealed formed sections, having provision for wire management. Top made of 25mm thick Pre-laminated Particle Board. Side Edges covered with PVC edge band on through feed edge banding machine. Dotted embossed cable Duct and Perforated steel modesty panel at visitor's side. All steel components are epoxy powder coated after seven tanks anti corrosion treatment of surface. The overall appearance of the product shall be as per photograph.	P.O.R

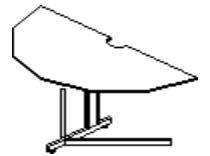

Sr. No.	Product Detail	Specification	Price
34	Non Sharing Linear Workstation Single Side Main Desk (1200mm x 600) without pedestal (Per Seat)COF-34	Non sharing linear workstation Main Desk (1200 x 600) without pedestal. Made of 25mm thick pre laminated particle board top with pvc edge bending. aluminium frame Screen of size 1050mm x 350mm in With fabric. Under structure of top made up of 50mm x 50mm x 1.6mm thick & 40mm x 40mm x 1.6mm thick erw tube. with provision of horizontal & vertical cable tray made up of 0.8mm cold rolled close annealed sheet curved with bottom & side pillar. All steel components are epoxy powder coated followed by saran tanks anti corrosion.	P.O.R



Sr. No.	Product Detail	Specification	Price
35	Non Sharing Linear Workstation Single Side Add-on Desk (1200mm x 600) without pedestal (Per Seat) COF-35	Non sharing linear workstation Add-on Desk (1200 x 600) without pedestal. Made of 25mm thick pre laminated particle board top with pvc edge bending. aluminium frame Screen of size 1050mm x 350mm in With fabric. Under structure of top made up of 50mm x 50mm x 1.6mm thick & 40mm x 40mm x 1.6mm thick erw tube. with provision of horizontal & vertical cable tray made up of 0.8mm cold rolled close annealed sheet curved with bottom & side pillar. All steel components are epoxy powder coated followed by seven tanks anti corrosion.	P.O.R



Sr. No.	Product Detail	Specification	Price
36	Sharing Linear Workstation Both Side Main Desk (1200mm x 1200) without pedestal (2 Seater) COF-36	Sharing linear workstation Main Desk (1200 x 1200) without pedestal. Made of 25mm thick pre laminated particle board top with pvc edge bending. aluminium frame Screen of size 1050mm x 350mm in With fabric. Under structure of top made up of 50mm x 50mm x 1.6mm thick & 40mm x 40mm x 1.6mm thick erw tube. With provision of horizontal & vertical cable tray made up of 0.8mm cold rolled close annealed sheet curved with bottom & side pillar. All steel components are epoxy powder coated followed by seven tanks anti corrosion	P.O.R



Sr. No.	Product Detail	Specification	Price
37	Sharing Linear Workstation Both Side Adon Desk (1200mm x 1200) without pedestal (2 Seater) COF-37	Sharing linear workstation Add-on Desk (1200 x 1200) without pedestal. Made of 25mm thick pre laminated particle board top with pic edge bending. Aluminum frame Screen of size 1050mm x 350mm in With fabric. Under structure of top made up of 50mm x 50mm x 1.6mm thick & 40mm x 40mm x 1.6mm thick erw tube. With provision of horizontal & vertical cable tray made up of 0.8mm cold rolled close annealed sheet curved with bottom & side pillar. All steel components are epoxy powder coated followed by seven tanks anti corrosion	P.O.R

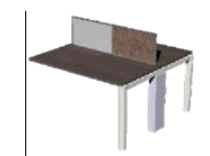

Sr. No.	Product Detail	Specification	Price
38	Desk Based Partition With Cable Duct COF-38	Size: - Length: 900/1200mm, thickness: 65mm, Height: 475mm, Frame made of cold rolled close annealed Steel Structure. Use only MIG/TIG & Spot welding for fabrication. Provision for Cable and switches and tile - Soft board / White Board / Pre-laminated Particle Board. All steel components are epoxy powder coated after seven tanks anti corrosion treatment of surface. The overall appearance of the product shall be as per photograph.	P.O.R



Sr. No.	Product Detail	Specification	Price
39	Desk Mounting Cable Duct COF-39	Size: - Length: 900/1200mm Width: 65mm, Height: 125mm, Frame made of cold rolled close annealed Steel Structure. Use only MIG/TIG & Spot welding for fabrication. Provision for Cable and switches. All steel components are epoxy powder coated after seven tanks anti corrosion treatment of surface. The overall appearance of the product shall be as per photograph.	P.O.R



Sr. No.	Product Detail	Specification	Price
40	21mm thk Partition Panel (Subject to actual measurement at site) COF-40	Modular panel based partition frame are made of Extruded Aluminum sections. The different types of Aluminum profiles used in frame structure of modular partition 21 mm width. Side Panels are made of PLPB 18mm with 4mm thk Glass. Front panel are made of PLPB and Fabric / White Writing Board / Glass Panels. All Aluminum sections and steel components are powder coated after seven tank anti corrosion treatments.	P.O.R

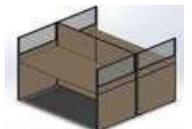

Sr. No.	Product Detail	Specification	Price
41	Partition Panel with Tiles (Subject to actual measurement at sight)COF-41	70mm. Thk. Tiles Base partition. Internal Frame are made by 1.6mm thk. cold rolled close annealed powder coated Sections. Tiles are made by 12mm. Thk. Pre laminate particle board. Tiles are also available in Glass, Fabric and Steel option. Frame structures are fabricated by MIG/TIG welding Machine. Tiles are fitted by high strength PVC Dowel in PVC Insert with transition fit. Provision of Slot for cabling and accessories. upper and side trim are 1mm thk. Extruded powder coated aluminum section and Pole is 1.6mm Thick Aluminum.	P.O.R



Sr. No.	Product Detail	Specification	Price
42	Partition Aluminum section with glass (Subject to actual measurement at sight)COF-42	70mm. Thk. Glass Base partition. Glass partition fitted with Aluminum section. Glass made of 08mm thick. Upper and side trim are 70mm thk. Extruded powder coated aluminum section and Pole is 1.6mm Thick Aluminum.	P.O.R



Sr. No.	Product Detail	Specification	Price
43	Aluminum section with glass door (Subject to actual measurement at sight)COF-43	Partition Aluminum section with glass door (Subject to actual measurement at sight) 70mm. Thk. Glass Base partition. Glass partition fitted with Aluminum section. Glass made of 08mm thick. Upper and side trim are 70mm thk. Extruded powder coated aluminum section and Pole is 1.6mm Thick Aluminum.	P.O.R



Sr. No.	Product Detail	Specification	Price
44	Work Top (Subject to actual measurement at sight)COF-44	Worktop are made of 25mm thick Pre-laminated Particle Board or in MDF in various design and shape. All exposed edges are covered with 2mm thk PVC edge bend by machine. Fitted to the partition with necessary M.S. cold rolled close annealed duly Powder Coated brackets.	P.O.R

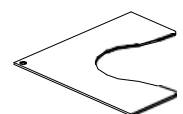

Sr. No.	Product Detail	Specification	Price
45	Side Panel/ Leg (18mm Pre-laminated Particle Board) COF-45	725mm Height Side panel/leg are made by 18mm thk. Pre-laminated Particle Board fitted with necessary bracket. All exposed edges are covered with 2mm thk. PVC edge bends by machine.	P.O.R

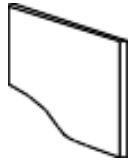

Sr. No.	Product Detail	Specification	Price
46	Full Leg (18mm Pre-laminated Particle Board) COF-46	1200mm Height Side panel/leg are made by 18mm thk. Pre-laminated Particle Board fitted with necessary bracket. All exposed edges are covered with 2mm thk. PVC edge bend by machine	P.O.R

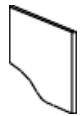

Sr. No.	Product Detail	Specification	Price
47	Side Panel/ Leg (Metal) COF-47	735mm Height, C- Frame Leg made by aluminum profile and cold rolled close annealed formed sections, having provision for wire management. Fitted with necessary brackets to fix with partition and work Top. All steel components are epoxy powder coated after seven tanks anti corrosion treatment of surface. The overall appearance of the product shall be as per photograph.	P.O.R

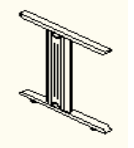

Sr. No.	Product Detail	Specification	Price
48	Mobile Pedestal unit (Pre-laminated Particle Board) COF-48	Size: Height: 650mm, Width: 400mm, Depth: 450mm Top made of 18mm thick Pre-laminated Particle Board. Side, back and drawer front are made by 18mm thk. Pre-laminated Particle Board. Metallic finish heavy duty handle. Superior quality makes front mounted lock. Provision of Casters for mobility. Special drawer slides for filing drawer. Other drawers on roller slides. Overall appearance of product as per photograph.	P.O.R



Sr. No.	Product Detail	Specification	Price
49	Pedestal –DR COF-49	Size : Height : 610m, With : 400mm, Depth :450mm, Body part made-up of prime quality cold rolled close annealed Sheet use only MIG/TIG & sport welding for fabrication, Body made of 0.8mm thick cold rolled close annealed Sheet. Drawer with Telescopic Channel slides. Superior quality make multi drawer front lock. Drawer front in cold rolled close annealed M.S. Sheet 0.8mm thk. Provision of casters for mobility. All steel components are epoxy powder coated followed by seven tank anti corrosion treatment of surface. The overall appearance of the product shall be as per photograph.	P.O.R



Sr. No.	Product Detail	Specification	Price
50	Side Runner-SDU with drawer COF-50	Size: Height: 750mm, Width: 900mm, Depth: 400mm. Body part made-up of prime quality cold rolled close annealed Sheet Use only MIG/TIG & Spot welding for fabrication. Top made of 18mm thick Pre- laminated Particle Board. Side Edges covered with PVC edge band on edge bending machine. Provision of drawer below table top with telescopic channel. Superior Quality make lock. PVC handles. Doors in cold rolled close annealed M.S. Sheet. Doors are Top hung slide on roller bearing. All steel components are epoxy powder coated followed by seven tanks anti corrosion treatment of surface. The overall appearance of the product shall be as per photograph.	P.O.R



Sr. No.	Product Detail	Specification	Price
51	SDU with Top Length 1300mm COF-51	Size: Height: 750mm, Width: 900mm, Depth: 400mm Body part made-up of prime quality CRCA Sheet Use only MIG/TIG & Spot welding for fabrication. Top made of 18mm thick PLPB. Side Edges covered with PVC edge band on edge bending machine. Provision of drawer below table top with telescopic channel. Door set make lock. PVC/ Aluminum handles. Doors in PLPB/CRCA M.S. Sheet. Doors are Top hung slide on roller bearing. All steel components should be epoxy powder coated followed by seven tanks anti corrosion treatment of surface. The overall appearance of the product shall be as per photograph.	P.O.R



Sr. No.	Product Detail	Specification	Price
52	MSU-Door Unit COF-52	Size: Height:640mm, Width:350mm, Depth:525mm Body part made-up of prime quality cold rolled close annealed Sheet Use only MIG/TIG & Spot welding for fabrication. Top made of 18mm thick. Side Edges covered with PVC edge band on edge bending machine. Door set make lock. Door in cold rolled close annealed M.S. Sheet. Provision of castors for mobility. All steel components should be epoxy powder coated followed by seven tanks anti corrosion treatment of surface. The overall appearance of the product shall be as per photograph.	P.O.R



Sr. No.	Product Detail	Specification	Price
53	SU-3D COF-53	Size : Width:350mm depth: 575mm xHeight:430mm Body part made-up of prime quality cold rolled close annealed Sheet Use only MIG/TIG & Spot welding for fabrication. Drawer with telescopic channel. Door set make lock. Drawer front in cold rolled close annealed M.S. Sheet. All steel components are epoxy powder coated followed by seven tanks anti corrosion treatment of surface. The overall appearance of the product shall be as per photograph.	P.O.R



Sr. No.	Product Detail	Specification	Price
54	SU-Door unit COF-54	Size : Width:350mm depth: 575mm xHeight:430mm Body part made-up of prime quality cold rolled close annealed Sheet Use only MIG/TIG & Spot welding for fabrication. Door set make lock. Door in cold rolled close annealed M.S. Sheet. All steel components are epoxy powder coated followed by seven tanks anti corrosion treatment of surface. The overall appearance of the product shall be as per photograph.	P.O.R

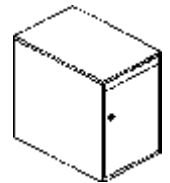

Sr. No.	Product Detail	Specification	Price
55	Wall Storage COF-55	Size : Length-1200mm, Depth-450mm, Height-450mm, Made Of 18mm thick Pre-laminated Particle Board.	P.O.R

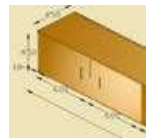

Sr. No.	Product Detail	Specification	Price
56	SDU-1200 COF-56	Size: Height: 1200mm, Width: 900mm, Depth: 400mm Body part made-up of prime quality cold rolled close annealed Sheet Use only MIG/TIG & Spot welding for fabrication. Top made of 18mm thick Pre- laminated Particle Board. Side Edges covered with PVC edge band on edge bending machine. Door set make lock. PVC handles. Doors in cold rolled close annealed M.S. Sheet. Doors are Top hung slide on roller bearing. All steel components are epoxy powder coated followed by seven tanks anti corrosion treatment of surface. The overall appearance of the product shall be as per photograph.	P.O.R



Sr. No.	Product Detail	Specification	Price
57	SDU-750 COF-57	Size:- Height:750mm,Width:900mm, Depth:400mm Body part made-up of prime quality cold rolled close annealed Sheet Use only MIG/TIG & Spot welding for fabrication. Top made of 18mm thick Pre- laminated Particle Board. Side Edges covered with PVC edge band on edge bending machine. Door set make lock. PVC handles. Doors in cold rolled close annealed M.S. Sheet. Doors are Top hung slide on roller bearing. All steel components are epoxy powder coated followed by seven tanks anti corrosion treatment of surface. The overall appearance of the product shall be as per photograph.	P.O.R



Sr. No.	Product Detail	Specification	Price
58	FC-4D COF-58	Size:- Height:1290mm,Width:474mm, Depth:620mm Body part made-up of prime quality cold rolled close annealed Sheet Use only MIG/TIG & Spot welding for fabrication. Drawer slide on pvc roller bearing slides. Lock front mounting Ebco / Door set make. Inbuilt type drawer handles. All steel components are epoxy powder coated followed by seven tanks anti corrosion treatment of surface. The overall appearance of the product shall be as per photograph	P.O.R



Sr. No.	Product Detail	Specification	Price
59	FC-2D COF-59	Size:- Height:680mm,Width:474mm, Depth:620mm Body part made-up of prime quality cold rolled close annealed Sheet Use only MIG/TIG & Spot welding for fabrication. Drawer slide on pvc roller bearing slides. Lock front mounting Ebco / Door set make. Inbuilt type drawer handles. All steel components are epoxy powder coated followed by seven tanks anti corrosion treatment of surface. The overall appearance of the product shall be as per photograph.	P.O.R



Sr. No.	Product Detail	Specification	Price
60	BC-2D COF-60	Size:- Height:925mm, Width:838mm, Depth:310 mm (2-door) Body part made-up of prime quality cold rolled close annealed Sheet Use only MIG/TIG & Spot welding for fabrication. Doors made of MS cold rolled close annealed formed sections fitted with 4mm thk glass. Doors open and slide on pvc rollers. Lock front mounting superior quality make. All steel components are epoxy powder coated followed by seven tanks anti corrosion treatment of surface. The overall appearance of the product shall be as per photograph.	P.O.R



Sr. No.	Product Detail	Specification	Price
61	BC-4D COF-61	Size:- Height:1675mm, Width:838mm, Depth:310mm (4-Door) Body part made-up of prime quality cold rolled close annealed Sheet Use only MIG/TIG & Spot welding for fabrication. Doors made of MS cold rolled close annealed formed sections fitted with 4mm thk glass. Doors open and slide on pvc rollers. Lock front mounting superior quality make. All steel components are epoxy powder coated followed by seven tanks anti corrosion treatment of surface. The overall appearance of the product shall be as per photograph.	P.O.R



r. No.	Product Detail	Specification	Price
62	BC-4D- NEW COF-62	Size: - Height: 1750mm, Width: 920 mm, Depth: 330 mm (4-Door) Material Prime quality CRCA sheet 0.8mm thick. Compartment door: Each compartment shall provide to-hung glass door, which swings, open upwards and slides into the casing when fully open by means of rollers. The overall size of glass 3mm thickness shall be such, that all the books in compartment shall be visible. For proper alignment of glass door cross plate (Patti) arrangement i.e. scissor system is to be fitted in each door. Construction: All the components are neat and clean with strong joints. Lock & Handles: Two Nos. good quality handles are provided on each door with precision lock. Key shall be common for all compartment lock. Finish: The bookcase shall be powder coated after seven tanks pre-treatment. The overall appearance of the product shall be as per photograph.	P.O.R



Sr. No.	Product Detail	Specification	Price
63	BSBC-5D COF-63	Size:- Height:1950mm, Width:838 mm, Depth:610mm (5 doors- Both side) Body part made-up of prime quality cold rolled close annealed Sheet Use only MIG/TIG & Spot welding for fabrication. Doors made of MS cold rolled close annealed formed sections fitted with 4mm thk glass. Doors open and slide on pvc rollers. Lock front mounting superior quality make. All steel components are epoxy powder coated followed by seven tanks anti corrosion treatment of surface. The overall appearance of the product shall be as per photograph	P.O.R

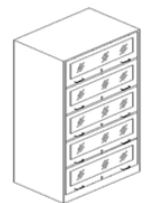

Sr. No.	Product Detail	Specification	Price
64	AL-01 COF-64	Size:-height:1980mm width:910mm depth:485mm Body part made-up of prime quality cold rolled close annealed Sheet Use only MIG/TIG & Spot welding for fabrication.4 adjustable shelf. Three way locking device with six levers superior quality lock for Door. Doors are mounted on steel hinge brackets. Body 22 Gauge, Door 20 Gauge. All steel components are epoxy powder coated followed by seven tanks anti corrosion treatment of surface. The overall appearance of the product shall be as per photograph.	P.O.R



Sr. No.	Product Detail	Specification	Price
65	AL-01L COF-65	Size:-height:1980mm, width:910mm depth:485mm Body part made-up of prime quality cold rolled close annealed Sheet Use only MIG/TIG & Spot welding for fabrication.1 adjustable shelf, one locker along with width. Three way locking device with six levers superior quality lock for Door. Doors are mounted on steel hinge brackets. All steel components are epoxy powder coated followed by seven tanks anti corrosion treatment of surface. The overall appearance of the product shall be as per photograph.	P.O.R



Sr. No.	Product Detail	Specification	Price
66	AL-02 COF-66	Size:-height:1270mm, width:760mm depth:430mm Body part made-up of prime quality cold rolled close annealed Sheet Use only MIG/TIG & Spot welding for fabrication. 2 adjustable shelf .Three way locking device with six levers superior quality lock for Door . Doors are mounted on steel hinge brackets. All steel components are epoxy powder coated followed by seven tanks anti corrosion treatment of surface. The overall appearance of the product shall be as per photograph.	P.O.R

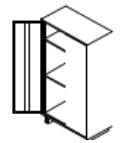

Sr. No.	Product Detail	Specification	Price
67	AL-02L COF-67	Size :- height:1270mm, width:760mm depth:430mm Body part made-up of prime quality cold rolled close annealed Sheet Use only MIG/TIG & Spot welding for fabrication. One locker along with width .Three way locking device with six levers superior quality lock for Door. Doors are mounted on steel hinge brackets. All steel components are epoxy powder coated followed by seven tanks anti corrosion treatment of surface. The overall appearance of the product shall be as per photograph.	P.O.R



Sr. No.	Product Detail	Specification	Price
68	AL-02GD COF-68	Size:-height:1980mm, width:910mm depth:380mm Body part made-up of prime quality cold rolled close annealed Sheet Use only MIG/TIG & Spot welding for fabrication.5 adjustable shelf. Three way locking device with six levers superior quality lock for Door . Doors made of press formed MS cold rolled close annealed sections with 4mm glass. Doors are mounted on steel hinge brackets. All steel components are epoxy powder coated followed by seven tanks anti corrosion treatment of surface. The overall appearance of the product shall be as per photograph.	P.O.R



Sr. No.	Product Detail	Specification	Price
69	AL-04GD COF-69	Size:-height:1980mm, width:910mm, depth:560mm (Both side open able 4 doors) Body part made-up of prime quality cold rolled close annealed Sheet Use only MIG/TIG & Spot welding for fabrication. 5 adjustable shelf. Three way locking device with six levers superior quality lock for Door. Doors made of press formed MS cold rolled close annealed sections with 4mm glass. Doors are mounted on steel hinge brackets. All steel components are epoxy powder coated followed by seven tanks anti corrosion treatment of surface. The overall appearance of the product shall be as per photograph.	P.O.R



Sr. No.	Product Detail	Specification	Price
70	IL-6D COF-70	Size:- Height:1980mm, Width:915mm, Depth:485mm(6 door), Body part made-up of prime quality cold rolled close annealed Sheet Use only MIG/TIG & Spot welding for fabrication. Individual compartment having individual door, with six levers superior quality lock. Louvers are provided in doors for ventilation. Doors are mounted on steel hinge brackets. All steel components are epoxy powder coated followed by seven tanks anti corrosion treatment of surface. The overall appearance of the product shall be as per photograph.	P.O.R

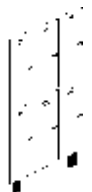

Sr. No.	Product Detail	Specification	Price
71	IL-9D COF-71	Size:- Height:1980mm, Width:915mm, Depth:485mm (9 doors) Body part made-up of prime quality cold rolled close annealed Sheet Use only MIG/TIG & Spot welding for fabrication. Individual compartment having individual door, with six levers superior quality lock. Louvers are provided in doors for ventilation. Doors are mounted on steel hinge brackets. All steel components are epoxy powder coated followed by seven tanks anti corrosion treatment of surface. The overall appearance of the product shall be as per photograph.	P.O.R

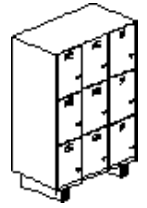

Sr. No.	Product Detail	Specification	Price
72	IL-12D COF-72	Size:- Height:1980mm, Width:915mm, Depth: 485mm (12 doors), Body part made-up of prime quality cold rolled close annealed Sheet Use only MIG/TIG & Spot welding for fabrication. Individual compartment having individual door, with six levers superior quality lock. Louvers are provided in doors for ventilation. Doors are mounted on steel hinge brackets. All steel components are epoxy powder coated followed by seven tanks anti corrosion treatment of surface. The overall appearance of the product shall be as per photograph.	P.O.R

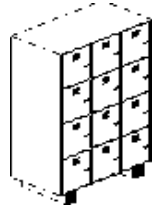

Sr. No.	Product Detail	Specification	Price
73	PH-10 COF-73	Size:- Height:1980mm, Width:915mm, Depth: 485mm (10 Hole), Body part made-up of prime quality cold rolled close annealed Sheet Use only MIG/TIG & Spot welding for fabrication. Special Pigeon hole construction to keep diff material as shown in picture .Three way locking device with six levers superior quality lock for Door . Doors are mounted on steel hinge brackets. All steel components are epoxy powder coated followed by seven tanks anti corrosion treatment of surface. The overall appearance of the product shall be as per photograph.	P.O.R

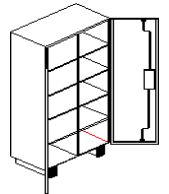

Sr. No.	Product Detail	Specification	Price
74	PH-18 COF-74	Size:- Height:1980mm, Width:915mm, Depth: 485mm (18 holes), Body part made-up of prime quality cold rolled close annealed Sheet Use only MIG/TIG & Spot welding for fabrication. Special Pigeon hole construction to keep diff material as shown in picture .Three way locking device with six levers superior quality lock for Door . Doors are mounted on steel hinge brackets. All steel components are epoxy powder coated followed by seven tanks anti corrosion treatment of surface. The overall appearance of the product shall be as per photograph.	P.O.R

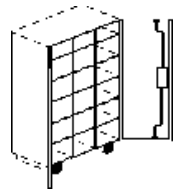

Sr. No.	Product Detail	Specification	Price
75	Locker Main Unit with 6 Door COF-75	Size:- Height:1950mm, Width:380mm, Depth:450mm (6 door), Body part made-up of prime quality cold rolled close annealed Sheet of 1mm & 0.8mm thickness, Use only Spot welding for fabrication. Knockdown constructions, Individual compartment having individual door, with six levers superior quality lock. Special Holes are provided in doors for ventilation. Doors are mounted on Pivot with steel handle. All steel components are epoxy powder coated followed by seven tanks anti corrosion treatment of surface. The overall appearance of the product shall be as per photograph.	P.O.R

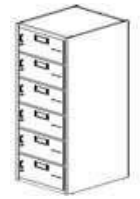

Sr. No.	Product Detail	Specification	Price
76	Locker Add-on Unit with 6 Door COF-76	Size:- Height:1950mm, Width:380mm, Depth:450mm (6 door), Body part made-up of prime quality cold rolled close annealed Sheet of 1mm & 0.8mm thickness, Use only Spot welding for fabrication. Knockdown constructions, Individual compartment having individual door, with six levers superior quality lock. Special Holes are provided in doors for ventilation. Doors are mounted on Pivot with steel handle. All steel components are epoxy powder coated followed by seven tanks anti corrosion treatment of surface. The overall appearance of the product shall be as per photograph.	P.O.R



Sr. No.	Product Detail	Specification	Price
77	Locker Main Unit with 5 Door COF-77	Size:- Height:1950mm, Width:380mm, Depth:450mm (5 door), Body part made-up of prime quality "cold rolled close annealed" Sheet of 1mm & 0.8mm thickness, Knockdown constructions, Individual compartment having individual door, with 5 multipurpose lock. Holes are provided in doors for ventilation. Doors are mounted on Pivot with steel handle. All steel components are epoxy powder coated followed by seven tanks anti corrosion treatment of surface. The overall appearance of the product shall be as per photograph.	P.O.R

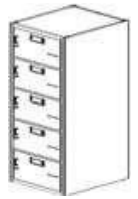

Sr. No.	Product Detail	Specification	Price
78	Locker Add-on Unit with 5 Door COF-78	Size:- Height:1950mm, Width:380mm, Depth:450mm (5 door),Body part made-up of prime quality "cold rolled close annealed" Sheet of 1mm & 0.8mm thickness, Knockdown constructions, Individual compartment having individual door, with 5 multipurpose lock. Holes are provided in doors for ventilation. Doors are mounted on Pivot with steel handle. All steel components are epoxy powder coated followed by seven tanks anti corrosion treatment of surface. The overall appearance of the product shall be as per photograph.	P.O.R

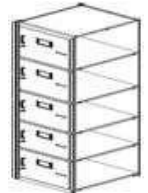

Sr. No.	Product Detail	Specification	Price
79	Locker Main Unit with 4 Door COF-79	Size:- Height:1950mm, Width:380mm, Depth:450mm (4 door), Body part made-up of prime quality "cold rolled close annealed" Sheet of 1mm & 0.8mm thickness, Knockdown constructions, Individual compartment having individual door, with 4 multipurpose lock. Holes are provided in doors for ventilation. Doors are mounted on Pivot with steel handle. All steel components are epoxy powder coated followed by seven tanks anti corrosion treatment of surface. The overall appearance of the product shall be as per photograph.	P.O.R



Sr. No.	Product Detail	Specification	Price
80	Locker Add-on Unit with 4 Door COF-80	Size:- Height:1950mm, Width:380mm, Depth:450mm (4 door), Body part made-up of prime quality "cold rolled close annealed" Sheet of 1mm & 0.8mm thickness, Knockdown constructions, Individual compartment having individual door, with 4 multipurpose lock. Holes are provided in doors for ventilation. Doors are mounted on Pivot with steel handle. All steel components are epoxy powder coated followed by seven tanks anti corrosion treatment of surface. The overall appearance of the product shall be as per photograph.	P.O.R

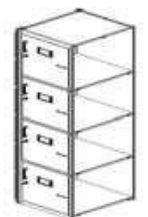

Sr. No.	Product Detail	Specification	Price
81	Locker Main Unit with 3 Door COF-81	Size:- Height:1950mm, Width:380mm, Depth:450mm (3 door), Body part made-up of prime quality "cold rolled close annealed" Sheet of 1mm & 0.8mm thickness, Knockdown constructions, Individual compartment having individual door, with 3 multipurpose lock. Holes are provided in doors for ventilation. Doors are mounted on Pivot with steel handle. Components are epoxy powder coated followed by seven tanks anti corrosion treatment of surface. The overall appearance of the product shall be as per photograph.	P.O.R

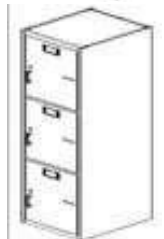

Sr. No.	Product Detail	Specification	Price
82	Locker Add on Unit with 3 Door COF-82	Size:- Height:1950mm, Width:380mm, Depth:450mm (3 door), Body part made-up of prime quality "cold rolled close annealed" Sheet of 1mm & 0.8mm thickness, Knockdown constructions, Individual compartment having individual door, with 3 multipurpose lock. Holes are provided in doors for ventilation. Doors are mounted on Pivot with steel handle. Components are epoxy powder coated followed by seven tanks anti corrosion treatment of surface. The overall appearance of the product shall be as per photograph.	P.O.R



Sr. No.	Product Detail	Specification	Price
83	COMPACTOR- Single Body-Fix- Main Unit COF-83	Size-900x380x2100 ht. The system has a rigid knock down construction made out of 0.8 mm thick cold rolled close annealed steel body. Adjustable shelves made up of 0.8mm thick cold rolled close annealed sheet. Bottom track channel is 100 x 25x2mm. With central locking arrangement. Each body has 5 loading levels adjustable shelves of load carrying capacity is 50 kg per shelf. All steel components are treated for anti rust surface and powder coated with epoxy polyester powder with dry film thickness of minimum 45-50 microns.	P.O.R



Sr. No.	Product Detail	Specification	Price
84	COMPACTOR- Single Body-Fix- Add-on Unit COF-84	Size- 900x380x2100 ht. The system has a rigid knock down construction made out of 0.8 mm thick cold rolled close annealed steel body. Adjustable shelves made up of 0.8 mm thick cold rolled close annealed sheet. Bottom track channel is 100 x 25 x 2mm. With central locking arrangement. Each body has 5 loading levels adjustable shelves of load carrying capacity is 50 kg per shelf. All steel components are treated for anti rust surface and powder coated with epoxy polyester powder with dry film thickness of minimum 45-50 microns.	P.O.R
85	COMPACTOR- Single Body- Mobile-Main Unit COF-85	Size-900x380x2100 ht. The system has a rigid knock down construction made out of 0.8 mm thick cold rolled close annealed steel body. Adjustable shelves made up of 0.8 mm thick cold rolled close annealed sheet. Bottom track channel is 100 x 25 x 2mm. With central locking arrangement. Each body has 5 loading levels adjustable shelves of load carrying capacity is 50 kg per shelf. All steel components are treated for anti rust surface and powder coated with epoxy polyester powder with dry film thickness of minimum 45-50 microns.	P.O.R
86	COMPACTOR- Single Body- Mobile-Add-on Unit COF-86	Size- 900x380x2100 ht. The system has a rigid knock down construction made out of 0.8 mm thick cold rolled close annealed steel body. Adjustable shelves made up of 0.8 mm thick cold rolled close annealed sheet. Bottom track channel is 100 x 25 x 2mm. With central locking arrangement. Each body has 5 loading levels adjustable shelves of load carrying capacity is 50 kg per shelf. All steel components are treated for anti rust surface and powder coated with epoxy polyester powder with dry film thickness of minimum 45-50 microns.	P.O.R
87	COMPACTOR- Double Body- Mobile-Main Unit COF-87	Size-900x760x2100 ht. The system has a rigid knock down construction made out of 0.8 mm thick cold rolled close annealed steel body. Adjustable shelves made up of 0.8 mm thick cold rolled close annealed sheet. Bottom track channel is 100 x 25 x 2mm. With central locking arrangement. Each body has 5 loading levels adjustable shelves of load carrying capacity is 50 kg per shelf. All steel components are treated for anti rust surface and powder coated with epoxy polyester powder with dry film thickness of minimum 45-50 microns.	P.O.R
88	COMPACTOR- Double Body- Mobile-Add-on Unit COF-88	Size-900x760x2100 ht. The system has a rigid knock down construction made out of 0.8 mm thick cold rolled close annealed steel body. Adjustable shelves made up of 0.8 mm thick cold rolled close annealed sheet. Bottom track channel is 100 x 25 x 2mm. With central locking arrangement. Each body has 5 loading levels adjustable shelves of load carrying capacity is 50 kg per shelf. All steel components are treated for anti rust surface and powder coated with epoxy polyester powder with dry film thickness of minimum 45-50 microns.	P.O.R
89	Additional For Mechanical Drive (each row) COF-89	Body structure made of 1 mm thick cold rolled close annealed sheet & internal structure made of machine parts, sprocket, chain etc. All machine parts should be Zink plated. All sheet metal components should be epoxy powder coated with anti corrosion treatment of surface.	P.O.R
90	COMPACTOR- Single Body-Fix- Main Unit COF-90	Size-900x450x2100 ht. The system has a rigid knock down construction made out of 0.8 mm thick cold rolled close annealed steel body. Adjustable shelves made up of 0.8 mm thick cold rolled close annealed sheet. Bottom track channel is 100 x 25 x 2mm. With central locking arrangement. Each body has 5 loading levels adjustable shelves of load carrying capacity is 50 kg per shelf. All steel components are treated for anti rust surface and powder coated with epoxy polyester powder with dry film thickness of minimum 45-50 microns.	P.O.R



Sr. No.	Product Detail	Specification	Price
91	COMPACTOR- Single Body-Fix- Add-on Unit COF-91	Size- 900x450x2100 ht. The system has a rigid knock down construction made out of 0.8 mm thick cold rolled close annealed steel body. Adjustable shelves made up of 0.8 mm thick cold rolled close annealed sheet. Bottom track channel is 100x25x2 mm. With central locking arrangement. Each body has 5 loading levels adjustable shelves of load carrying capacity is 50 kg per shelf. All steel components are treated for anti rust surface and powder coated with epoxy polyester powder with dry film thickness of minimum 45-50 microns.	P.O.R



Sr. No.	Product Detail	Specification	Price
92	COMPACTOR- Single Body- Mobile-Main Unit COF-92	Size-900x450x2100 ht. The system has a rigid knock down construction made out of 0.8 mm thick cold rolled close annealed steel body. Adjustable shelves made up of 0.8 mm thick cold rolled close annealed sheet. Bottom track channel is 100x25x2 mm. With central locking arrangement. Each body has 5 loading levels adjustable shelves of load carrying capacity is 50 kg per shelf. All steel components are treated for anti rust surface and powder coated with epoxy polyester powder with dry film thickness of minimum 45-50 microns.	P.O.R



Sr. No.	Product Detail	Specification	Price
93	COMPACTOR- Single Body- Mobile-Add-on Unit COF-93	Size- 900x450x2100 ht. The system has a rigid knock down construction made out of 0.8 mm thick cold rolled close annealed steel body. Adjustable shelves made up of 0.8 mm thick cold rolled close annealed sheet. Bottom track channel is 100x25x2 mm. With central locking arrangement. Each body has 5 loading levels adjustable shelves of load carrying capacity is 50 kg per shelf. All steel components are treated for anti rust surface and powder coated with epoxy polyester powder with dry film thickness of minimum 45-50 microns.	P.O.R



Sr. No.	Product Detail	Specification	Price
94	COMPACTOR- Double Body- Mobile-Main Unit COF-94	Size-900x900x2100 ht. The system has a rigid knock down construction made out of 0.8 mm thick cold rolled close annealed steel body. Adjustable shelves made up of 0.8 mm thick cold rolled close annealed sheet. Bottom track channel is 100x25x2 mm. With central locking arrangement. Each body has 5 loading levels adjustable shelves of load carrying capacity is 50 kg per shelf. All steel components are treated for anti rust surface and powder coated with epoxy polyester powder with dry film thickness of minimum 45-50 microns.	P.O.R



Sr. No.	Product Detail	Specification	Price
95	COMPACTOR- Double Body- Mobile-Add-on Unit COF-95	Size-900x900x2100 ht.. The system has a rigid knock down construction made out of 0.8 mm thick cold rolled close annealed steel body. Adjustable shelves made up of 0.8 mm thick cold rolled close annealed sheet. Bottom track channel is 100x25x2 mm. With central locking arrangement. Each body has 5 loading levels adjustable shelves of load carrying capacity is 50 kg per shelf. All steel components are treated for anti rust surface and powder coated with epoxy polyester powder with dry film thickness of minimum 45-50 microns.	P.O.R



Sr. No.	Product Detail	Specification	Price
96	Additional For Mechanical Drive (EACH ROW) COF-96	Body structure made of 1 mm thick cold rolled close annealed sheet & internal structure made of machine parts, sprocket, chain etc. All machine parts are Zink plated. All sheet metal components are epoxy powder coated with anti corrosion treatment of surface.	P.O.R

Sr. No.	Product Detail	Specification	Price
97	Nursery Desk 2 Seater with chairs COF-97	Size- L-1200mm x W-365 x H-450mm. MS under structure shelf frame made of CRCA Pipe 70x26x1.2mm powder coated with curvature top 18 mm PLPB. Shelf made of 12mm PLPB , Front panel CRCA 0.8mm sheet, Leg pip 1.2mm thick reduce pipe dia.	P.O.R



Sr. No.	Product Detail	Specification	Price
98	Nursery Desk Single Seater COF-98	Overall Dimensions: Seat: W-480mm x D-725mm x Ht-560mm Seat Structure: Made up of MS cold rolled close annealed tube dia 19mm x 1.2mm thk. Desk Structure: Made up of MS cold rolled close annealed Tube 25x25x1.25 thk MIG welded. Seat & Desktop made of 18mm thk Pre-laminated particle board. All steel components are epoxy powder coated followed by seven tanks anti corrosion treatment of surface. The overall appearance of the product shall be as per photograph.	P.O.R



Sr. No.	Product Detail	Specification	Price
99	Dual Desk DD-30 PLB 3-Seater COF-99	Overall Dimensions: Seat : W-1500mm x D-925mm x Ht-750mm Seat Structure: Made up of cold rolled close annealed MS Tube 50x25x1.25mm thk MIG welded to press formed MS cold rolled close annealed section 95x25x1.0 thk and MS cold rolled close annealed tube dia 25mm x1.2mm thk. Desk Structure: Made up of MS cold rolled close annealed Tube 50x25x1.25 thk MIG welded to press formed MS cold rolled close annealed section 95x25x1.0 thk. Seat & Desktop made of 18mm thick pre- laminated particle board. Side edges covered by teak wood polished rib. Provided book shelf below table top. All steel components are epoxy powder coated followed by seven tanks anti corrosion treatment of surface. The overall appearance of the product shall be as per photograph.	P.O.R



Sr. No.	Product Detail	Specification	Price
100	Dual Desk –DD-30 – 3-Seater with Post form Top COF-100	Overall Dimensions: Seat : W-1500mm x D-925mm x Ht-750mm Seat Structure: Made up of cold rolled close annealed MS Tube 50x25x1.25mm thk MIG welded to press formed MS cold rolled close annealed section 95x25x1.0 thk and MS cold rolled close annealed tube dia 25mm x1.2mm thk. Desk Structure: Made up of MS cold rolled close annealed Tube 50x25x1.25 thk MIG welded to press formed MS cold rolled close annealed section 95x25x1.0 thk. Seat & Desktop made of 18mm thick postform top.. Side edges covered by teak wood polished rib. Provided book shelf below table top. All steel components are epoxy powder coated followed by seven tanks anti corrosion treatment of surface. The overall appearance of the product shall be as per photograph.	P.O.R



Sr. No.	Product Detail	Specification	Price
101	Dual Desk DD-30 PLB COF-101	Overall Dimensions: Seat: W-1050mm x D-950/450 mm x Ht-760/450mm Seat Structure: Made up of cold rolled close annealed MS Tube 50x25x1.25mm thk MIG welded to press formed MS cold rolled close annealed section 95x25x1.0 thk and MS cold rolled close annealed tube dia 25mm x1.2mm thk. Desk Structure: Made up of MS cold rolled close annealed Tube 50x25x1.25 thk MIG welded to press formed MS cold rolled close annealed section 95x25x1.0 thk. Seat & Desktop made of 18mm thick pre- laminated particle board. Side edges covered by teak wood polished rib. Provided book shelf below table top. All steel components are epoxy powder coated followed by seven tanks anti corrosion treatment of surface. The overall appearance of the product shall be as per photograph.	P.O.R



Sr. No.	Product Detail	Specification	Price
102	DD-28 with pre-laminated particle board Top COF-102	Overall Dimensions: Seat : W-1050mm x D-950/450mm x Ht-710/425mm Seat Structure: Made up of cold rolled close annealed MS Tube 50x25x1.25mm thk MIG welded to press formed MS cold rolled close annealed section 95x25x1.0 thk and MS cold rolled close annealed tube dia 25mm x1.2mm thk. Desk Structure: Made up of MS cold rolled close annealed Tube 50x25x1.25 thk MIG welded to press formed MS cold rolled close annealed section 95x25x1.0 thk. Seat & Desktop made of 18mm thick pre- laminated particle board. Side edges covered by teak wood polished rib. Provided book shelf below table top. All steel components are epoxy powder coated followed by seven tanks anti corrosion treatment of surface. The overall appearance of the product shall be as per photograph. Note:- CLASS VI TO CLASS IX	P.O.R



Sr. No.	Product Detail	Specification	Price
103	DD-26 with pre-laminated particle board Top COF-103	Overall Dimensions: Seat : W-1050mm x D-950/450mm x Ht-660/400mm Seat Structure: Made up of cold rolled close annealed MS Tube 50x25x1.25mm thk MIG welded to press formed MS cold rolled close annealed section 95x25x1.0 thk and MS cold rolled close annealed tube dia 25mm x1.2mm thk. Desk Structure: Made up of MS cold rolled close annealed Tube 50x25x1.25 thk MIG welded to press formed MS cold rolled close annealed section 95x25x1.0 thk. Seat & Desktop made of 18mm thick pre-laminated particle board. Side edges covered by teak wood polished rib. Provided book shelf below table top. All steel components are epoxy powder coated followed by seven tanks anti corrosion treatment of surface. The overall appearance of the product shall be as per photograph. Note:- CLASS III TO CLASS V	P.O.R

Sr. No.	Product Detail	Specification	Price
104	DD-24 with pre-laminated particle board Top COF-104	Overall Dimensions: Seat : W-900mm x D-900/400 mm x Ht-610/375mm Seat Structure: Made up of cold rolled close annealed MS Tube 50x25x1.25mm thk MIG welded to press formed MS cold rolled close annealed section 95x25x1.0 thk and MS cold rolled close annealed tube dia 25mm x1.2mm thk. Desk Structure: Made up of MS cold rolled close annealed Tube 50x25x1.25 thk MIG welded to press formed MS cold rolled close annealed section 95x25x1.0 thk. Seat & Desktop made of 18mm thick pre-laminated particle board. Side edges covered by teak wood polished rib. Provided book shelf below table top. All steel components are epoxy powder coated followed by seven tanks anti corrosion treatment of surface. The overall appearance of the product shall be as per photograph. Note: - For Class-1st to Class 2nd.	P.O.R



Sr. No.	Product Detail	Specification	Price
105	DD-22 with pre-laminated particle board Top COF-105	Overall Dimensions: Seat : W-900mm x D-900/400mm x Ht-560/360mm Seat Structure: Made up of cold rolled close annealed MS Tube 50x25x1.25mm thk MIG welded to press formed MS cold rolled close annealed section 95x25x1.0 thk and MS cold rolled close annealed tube dia 25mm x1.2mm thk. Desk Structure: Made up of MS cold rolled close annealed Tube 50x25x1.25 thk MIG welded to press formed MS cold rolled close annealed section 95x25x1.0 thk. Seat & Desktop made of 18mm thick pre-laminated particle board. Side edges covered by teak wood polished rib. Provided book shelf below table top. All steel components are epoxy powder coated followed by seven tanks anti corrosion treatment of surface. The overall appearance of the product shall be as per photograph. Note: - For Class-1 st to Class 2 nd .	P.O.R



Sr. No.	Product Detail	Specification	Price
106	DD-18 with pre-laminated particle board Top COF-106	Overall Dimensions: Seat : W-900mm x D-900/400mm x Ht-460/300mm Seat Structure: Made up of cold rolled close annealed MS Tube 50x25x1.25mm thk MIG welded to press formed MS cold rolled close annealed section 95x25x1.0 thk and MS cold rolled close annealed tube dia 25mm x1.2mm thk. Desk Structure: Made up of MS cold rolled close annealed Tube 50x25x1.25 thk MIG welded to press formed MS cold rolled close annealed section 95x25x1.0 thk. Seat & Desktop made of 18mm thick pre-laminated particle board. Side edges covered by teak wood polished rib. Provided book shelf below table top. All steel components are epoxy powder coated followed by seven tanks anti corrosion treatment of surface. The overall appearance of the product shall be as per photograph. Note: - FOR KG-I TO KG-II.	P.O.R



Sr. No.	Product Detail	Specification	Price
107	Single Desk- 30 with pre-laminated particle board Top COF-107	Overall Dimensions: Seat : W-600mm x D-950/450mm x Ht-760/450mm Seat Structure: Made up of cold rolled close annealed MS Tube 50x25x1.25mm thk MIG welded to press formed MS cold rolled close annealed section 95x25x1.0 thk and MS cold rolled close annealed tube dia 25mm x1.2mm thk. Desk Structure: Made up of MS cold rolled close annealed Tube 50x25x1.25 thk MIG welded to press formed MS cold rolled close annealed section 95x25x1.0 thk. Seat & Desktop made of 18mm thick pre-laminated particle board. Side edges covered by teak wood polished rib. Provided book shelf below table top. All steel components are epoxy powder coated followed by seven tanks anti corrosion treatment of surface. The overall appearance of the product shall be as per photograph. Note:- FOR X TO COLLEGE	P.O.R



Sr. No.	Product Detail	Specification	Price
108	DD-30 with Post form Top COF-108	Overall Dimensions: Seat: W-1050mm x D-950/450mm x Ht-760/450mm Seat Structure: Made up of cold rolled close annealed MS Tube 50x25x1.25mm thk MIG welded to press formed MS cold rolled close annealed section 95x25x1.0 thk and MS cold rolled close annealed tube dia 25mm x1.2mm thk. Desk Structure: Made up of MS cold rolled close annealed Tube 50x25x1.25 thk MIG welded to press formed MS cold rolled close annealed section 95x25x1.0 thk. Seat & Desktop made of 18mm thick Postform top. Side edges covered by teak wood polished rib. Provided book shelf below table top. All steel components are epoxy powder coated followed by seven tanks anti corrosion treatment of surface. The overall appearance of the product shall be as per photograph. Note:- FOR X TO COLLEGE	P.O.R



Sr. No.	Product Detail	Specification	Price
109	DD-28 with Postform Top COF-109	Overall Dimensions: Seat : W-1050mm x D-950/450mm x Ht-710/425mm Seat Structure: Made up of cold rolled close annealed MS Tube 50x25x1.25mm thk MIG welded to press formed MS cold rolled close annealed section 95x25x1.0 thk and MS cold rolled close annealed tube dia 25mm x1.2mm thk. Desk Structure: Made up of MS cold rolled close annealed Tube 50x25x1.25 thk MIG welded to press formed MS cold rolled close annealed section 95x25x1.0 thk. Seat & Desktop made of 18mm thick Postform top. Side edges covered by teak wood polished rib. Provided book shelf below table top. All steel components are epoxy powder coated followed by seven tanks anti corrosion treatment of surface. The overall appearance of the product shall be as per photograph. Note:- CLASS VI TO CLASS IX	P.O.R



Sr. No.	Product Detail	Specification	Price
110	DD-26 with Postform Top COF-110	Overall Dimensions: Seat: W-1050mm x D-950/450mm x Ht-660/400mm Seat Structure: Made up of cold rolled close annealed MS Tube 50x25x1.25mm thk MIG welded to press formed MS cold rolled close annealed section 95x25x1.0 thk and MS cold rolled close annealed tube dia 25mm x1.2mm thk. Desk Structure: Made up of MS cold rolled close annealed Tube 50x25x1.25 thk MIG welded to press formed MS cold rolled close annealed section 95x25x1.0 thk. Seat & Desktop made of 18mm thick Postform top. Side edges covered by teak wood polished rib. Provided book shelf below table top. All steel components are epoxy powder coated followed by seven tanks anti corrosion treatment of surface. The overall appearance of the product shall be as per photograph. Note:- CLASS III TO CLASS V	P.O.R



Sr. No.	Product Detail	Specification	Price
111	DD-24 with Postform Top COF-111	Overall Dimensions: Seat : W-900mm x D-900/400mm x Ht-610/375mm Seat Structure: Made up of cold rolled close annealed MS Tube 50x25x1.25mm thk MIG welded to press formed MS cold rolled close annealed section 95x25x1.0 thk and MS cold rolled close annealed tube dia 25mm x1.2mm thk. Desk Structure: Made up of MS cold rolled close annealed Tube 50x25x1.25 thk MIG welded to press formed MS cold rolled close annealed section 95x25x1.0 thk. Seat & Desktop made of 18mm thick Postform top. Side edges covered by teak wood polished rib. Provided book shelf below table top. All steel components are epoxy powder coated followed by seven tanks anti corrosion treatment of surface. The overall appearance of the product shall be as per photograph. Note:- FOR KG II TO CLASS II	P.O.R



Sr. No.	Product Detail	Specification	Price
112	DD-22 with Postform Top COF-112	Overall Dimensions: Seat : W-900mm x D-900/400mm x Ht-560/360mm Seat Structure: Made up of cold rolled close annealed MS Tube 50x25x1.25mm thk MIG welded to press formed MS cold rolled close annealed section 95x25x1.0 thk and MS cold rolled close annealed tube dia 25mm x1.2mm thk. Desk Structure: Made up of MS cold rolled close annealed Tube 50x25x1.25 thk MIG welded to press formed MS cold rolled close annealed section 95x25x1.0 thk. Seat & Desktop made of 18mm thick postform top. Side edges covered by teak wood polished rib. Provided book shelf below table top. All steel components are epoxy powder coated followed by seven tanks anti corrosion treatment of surface. The overall appearance of the product shall be as per photograph. Note:- For Class-1 st to Class 2 nd .	P.O.R



Sr. No.	Product Detail	Specification	Price
113	DD-18 with Postform Top COF-113	Overall Dimensions: Seat : W-900mm x D-900/400mm x Ht-460/300mm Seat Structure: Made up of cold rolled close annealed MS Tube 50x25x1.25mm thk MIG welded to press formed MS cold rolled close annealed section 95x25x1.0 thk and MS cold rolled close annealed tube dia 25mm x1.2mm thk. Desk Structure: Made up of MS cold rolled close annealed Tube 50x25x1.25 thk MIG welded to press formed MS cold rolled close annealed section 95x25x1.0 thk. Seat & Desktop made of 18mm thick Postform top. Side edges covered by teak wood polished rib. Provided book shelf below table top. All steel components are epoxy powder coated followed by seven tanks anti corrosion treatment of surface. The overall appearance of the product shall be as per photograph. Note: - FOR NUR. II TO KG I	P.O.R



Sr. No.	Product Detail	Specification	Price
114	Single Desk-30 Post form top COF-1114	Overall Dimensions: Seat : W-600mm x D-950/450mm x Ht-760/450mm Seat Structure: Made up of cold rolled close annealed MS Tube 50x25x1.25mm thk MIG welded to press formed MS cold rolled close annealed section 95x25x1.0 thk and MS cold rolled close annealed tube dia 25mm x1.2mm thk. Desk Structure: Made up of MS cold rolled close annealed Tube 50x25x1.25 thk MIG welded to press formed MS cold rolled close annealed section 95x25x1.0 thk. Seat & Desktop made of 18mm thick Post form top. Side edges covered by teak wood polished rib. Provided book shelf below table top. All steel components are epoxy powder coated followed by seven tanks anti corrosion treatment of surface. The overall appearance of the product shall be as per photograph. Note:- FOR X TO COLLEGE	P.O.R



Sr. No.	Product Detail	Specification	Price
115	Dual Desk with Wooden perforated seat, back & Post form top COF-115	Overall Dimensions: Seat : W-1065mm x D-1000mm x Ht-750mm: Seat Structure: Made up of cold rolled close annealed MS Tube 50x25x1.25mm thk MIG welded to press formed MS cold rolled close annealed section 95x25x1.0 thk and MS cold rolled close annealed tube 20x40x1.2mm thk. Desk Structure: Made up of MS cold rolled close annealed Tube 50x25x1.25 thk MIG welded to press formed MS cold rolled close annealed section 95x25x1.0 thk. Desktop made of 18mm thick Post form. Seat and back are wooden moulded veneer faced mounted on 19mm dia 1.2mm thk tubular structure. Side edges of Top covered by teak wood polished rib. Provided book shelf below table top. All steel components are epoxy powder coated followed by seven tanks anti corrosion treatment of surface. The overall appearance of the product shall be as per photograph.	P.O.R



Sr. No.	Product Detail	Specification	Price
116	Dual Desk with Wooden perforated seat, back & plb top COF-116	Overall Dimensions: Seat : W-1065mm x D-1000mm x Ht-750mm: Seat Structure: Made up of cold rolled close annealed MS Tube 50x25x1.25mm thk MIG welded to press formed MS cold rolled close annealed section 95x25x1.0 thk and MS cold rolled close annealed tube 20x40x1.2mm thk. Desk Structure: Made up of MS cold rolled close annealed Tube 50x25x1.25 thk MIG welded to press formed MS cold rolled close annealed section 95x25x1.0 thk. Desktop made of 18mm thick pre-laminated particle board. Seat and back are wooden moulded veneer faced mounted on 19mm dia 1.2mm thick tubular structure. Side edges of Top covered by teak wood polished rib. Provided book shelf below table top. All steel components are epoxy powder coated followed by seven tanks anti corrosion treatment of surface. The overall appearance of the product shall be as per photograph.	P.O.R



Sr. No.	Product Detail	Specification	Price
117	4000 Front Row – Only Desk with book shelf COF-117	Front Row Overall Size :- W480mm, D405mm, H770mm, Top- H750mm. Tablet size :- W430mm, D315mm, 12mm thick, Front mould size : Height 467mm, Width 478mm, 12mm thick, :- Mounted on 64mmx64mmx3mm aluminum glide fitted with MS cold rolled close annealed leg made of 60mmx60mmx2mm MS tube and MS sheet 3mm thick covered with nylon cap. Front of desk & back of chair made of 12mm thick hot pressed ply with 0.6mm thk Laminates. Foldable seat made of 12mm thick hot pressed ply with 0.6mm thk Laminates. Tablet made of 12mm thick postform on MDF board with 0.6mm thk Laminates. Sliding & foldable in specially designed nylon mould accessories fitted on top aluminum glide of 30mmx70mm. All steel components are powder coated while aluminum glides are anodized or powder coated. Book Shelf- Overall Size: - W- 370mm, D-91mm, H-195mm, Made up of prime quality MS cold rolled close annealed sheet of 3mm thk. With Slot perforation and holes for fitting on desk. Tray is epoxy powder coated after seven tanks anti corrosion treatment of surface.	P.O.R



	Overall appearance of the product as shown in photograph. Note: Floor must be minimum 100mm thick RCC slab to grout the desk or otherwise written confirmation on deviation should be taken by Bonton, as regard to floor. Steps depth must be as per layout – deviations must be discussed with Bonton and written consent of Bonton is must in this regard before placing the order.	
--	----------------------------------------------------------------------------------------------------------------------------------------------------------------------------------------------------------------------------------------------------------------------------------------------------------------------------------------------------------------------------------------------	--

Sr. No.	Product Detail	Specification	Price
118	4000 Middle Row - Desk with Bench with book shelf COF-118	<p>Middle Row Overall Size: - Width 480mm, Depth 800mm, Height 770mm, Top- H750mm. Tablet size :- Width 430mm, Depth 315mm, 12mm thick, Seat size :- Width 477mm, Depth 377mm, 12mm thick, Back mould size : Height 467mm, Width 478mm, 12mm thick, Mounted on 64mmx64mmx3mm aluminum glide fitted with MS cold rolled close annealed leg made of 60mmx60mmx2mm MS tube and MS sheet 3mm thick covered with nylon cap. Front of desk & back of chair made of 12mm thick hot pressed ply with 0.6mm thk Laminates. Foldable seat made of 12mm thick hot pressed ply with 0.6mm thk Laminates. Tablet made of 12mm thick postform on MDF board with 0.6mm thk Laminates. Sliding & foldable in specially designed nylon mould accessories fitted on top aluminum glide of 30mmx70mm. All steel components are powder coated while aluminum glides are anodized or powder coated. Book Shelf- Overall Size: - W-370mm, D-91mm, H-195mm, Made up of prime quality MS cold rolled close annealed sheet of 3mm thk. With Slot perforation and holes for fitting on desk. Tray is epoxy powder coated after seven tanks anti corrosion treatment of surface.</p> <p>Overall appearance of the product as shown in photograph. Note: Floor must be minimum 100mm thick RCC slab to grout the chairs or otherwise written confirmation on deviation should be taken by Bonton, as regard to floor. Steps depth must be as per layout – deviations must be discussed with Bonton and written consent of Bonton is must in this regard before placing the order.</p>	P.O.R



Sr. No.	Product Detail	Specification	Price
119	4000 Back Row- Only Bench COF-119	<p>Back Row Overall Size :- Width 480mm, Depth 580mm, Seat Size : Width 477mm, Depth 377mm, 12mm thick, Seat Height 460mm. Back mould size : Height 467mm, Width 478mm, 12mm thick, Mounted on 64mmx64mmx3mm aluminium glide fitted with MS cold rolled close annealed leg made of 60mmx60mmx2mm MS tube and MS sheet 3mm thick covered with nylon cap. Back of chair made of 12mm thick hot pressed ply with 0.6mm thk Laminates. Foldable seat made of 12mm thick hot pressed ply with 0.6mm thk Laminates. Tablet made of 12mm thick post form on MDF board with 0.6mm thk Laminates. Sliding & foldable in specially designed nylon mould accessories fitted on top aluminium glide of 30mmx70mm. All steel components are powder coated while aluminium glides are anodized or powder coated.</p> <p>Overall appearance of the product as shown in photograph. Note: Floor must be minimum 100mm thick RCC slab to grout the chairs or otherwise written confirmation on deviation should be taken by Bonton, as regard to floor. Steps depth must be as per layout – deviations must be discussed with Bonton and written consent of Bonton is must in this regard before placing the order.</p>	P.O.R



Sr. No.	Product Detail	Specification	Price
120	4000 Middle Row – Desk with Bench with cushion. With book shelf COF-120	<p>Middle Row Overall Size :- W480mm, D800mm, H770mm, Top- H750mm. Tablet size :- W430mm, D315mm, 12mm thick, Back mould size : Height 467mm, Width 478mm, 12mm thick, :- Mounted on 64mmx64mmx3mm aluminium glide fitted with MS cold rolled close annealed leg made of 60mmx60mmx2mm MS tube and MS sheet 3mm thick covered with nylon cap. Middle row of foldable seat & back with 15mm thick PU Foam on plywood and fully covered with upholstery cloth. Tip up foldaway writing table with antipanic movement. Made up of 12mm thick postformed on MDF board with 0.6mm thk Laminates. All steel components are powder coated while aluminum glides are anodized or 20owder coated. Book Shelf- Overall Size :- W-370mm, D-91mm, H-195mm, Made up of prime quality MS cold rolled close annealed sheet of 3mm thk. With Slot perforation and holes for fitting on desk. Tray is epoxy powder coated after seven tanks anti corrosion treatment of surface.</p> <p>Overall appearance of the product as shown in photograph. Note: Floor must be minimum 100mm thick RCC slab to grout the chairs or otherwise written confirmation on deviation should be taken by Bonton, as regard to floor. Steps depth must be as per layout – deviations must be discussed with Bonton and written consent of Bonton is must in this regard before placing the order.</p>	P.O.R



Sr. No.	Product Detail	Specification	Price
121	4000 Back Row- Only Bench with cushion. COF-121	Back Row Overall Size: - W480mm, D580mm, H770mm, Seat size: - W477mm, D377mm, 12mm thick, Seat Height 460mm. Back mould size : Height 467mm, Width 478mm, 12mm thick:- Mounted on 64mmx64mmx3mm aluminum glide fitted with MS cold rolled close annealed leg made of 60mm x60mm x2mm MS tube and MS sheet 3mm thick covered with nylon cap. Back row of foldable seat back with 15mm thick, PU Foam on plywood and fully covered with upholstery cloth. All steel components are powder coated while aluminum glides are anodized or powder coated. Overall appearance of the product as shown in photograph. Note: Floor must be minimum 100mm thick RCC slab to grout the chairs or otherwise written confirmation on deviation should be taken by Bonton, as regard to floor. Steps depth must be as per layout – deviations must be discussed with Bonton and written consent of Bonton is must in this regard before placing the order.	P.O.R



Sr. No.	Product Detail	Specification	Price
122	4000 Cable And Switch Socket Arrangement For One Seat COF-122	Cable Arrangement – PVC Channel 25x25, Electrical Switch – 01 no And Electrical Socket – 01 no With PVC Box. To be Fitted on desk. The overall appearance of the product shall be as per Image.	P.O.R



Sr. No.	Product Detail	Specification	Price
123	GD-Main (two Seated) COF-123	Size- Width1116mm, Size D-450mm, Ht 750mm: Structure made up of M.S.cold rolled close annealed 1.6mm thick pedestal welded to press formed MS cold rolled close annealed section 95x25x1.0mm thk. Desktop made of 18mm thick pre-laminated particle board. Side edges covered by teak wood polished rib. Book self provided below top. Grouted by anchor bolt. All steel components are epoxy powder coated followed by seven tanks anti corrosion treatment of surface. The overall appearance of the product shall be as per photograph. Note: Floor must be minimum 100mm thick RCC slab to grout the chairs or otherwise written confirmation on deviation should be taken by Bonton, as regard to floor. Steps depth must be as per layout – deviations must be discussed with Bonton and written consent of Bonton is must in this regard before placing the order.	P.O.R



Sr. No.	Product Detail	Specification	Price
124	GD-Add-on two seated COF-124	Size- Width1088mm, Size D-450mm, Ht 760mm: Structure made up of M.S.cold rolled close annealed 1.6mm thick pedestal welded to press formed MS cold rolled close annealed section 95x25x1.0mm thk. Desktop made of 18mm thick pre-laminated particle board. Side edges covered by teak wood polished rib. Book self provided below top. Grouted by anchor bolt. All steel components are epoxy powder coated followed by seven tanks anti corrosion treatment of surface. The overall appearance of the product shall be as per photograph. Note: Floor must be minimum 100mm thick RCC slab to grout the chairs or otherwise written confirmation on deviation should be taken by Bonton, as regard to floor. Steps depth must be as per layout – deviations must be discussed with Bonton and written consent of Bonton is must in this regard before placing the order.	P.O.R



Sr. No.	Product Detail	Specification	Price
125	GD-Main (Single Seated) COF-125	Size- Width: 608mm, Size D-450 mm, Ht 760mm: Structure made up of M.S.cold rolled close annealed 1.6mm thick pedestal welded to press formed MS cold rolled close annealed section 95x25x1.0mm thk. Desktop made of 18mm thick pre-laminated particle board. Side edges covered by teak wood polished rib. Book self provided below Top. Grouted by anchor bolt. All steel components are epoxy powder coated followed by seven tanks anti corrosion treatment of surface. The overall appearance of the product shall be as per photograph. Note: Floor must be minimum 100mm thick RCC slab to grout the chairs or otherwise written confirmation on deviation should be taken by Bonton, as regard to floor. Steps depth must be as per layout – deviations must be discussed with Bonton and written consent of Bonton is must in this regard before placing the order.	P.O.R



Sr. No.	Product Detail	Specification	Price
126	BT-GD-Add-on single seated COF-126	Overall Dimensions: W580mm x D450 mm x Ht 760mm: Structure made up of M.S.cold rolled close annealed 1.6mm thick pedestal welded to press formed MS cold rolled close annealed section 95x25x1.0mm thk. Desktop made of 18mm thick pre-laminated particle board. Side edges covered by teak wood polished rib. Book self provided below top. Grouted by anchor bolt. All steel components are epoxy powder coated followed by seven tanks anti corrosion treatment. The overall appearance of the product shall be as per photograph. Note: Floor must be minimum 100mm thick RCC slab to grout the chairs or otherwise written confirmation on deviation should be taken by Bonton, as regard to floor. Steps depth must be as per layout – deviations must be discussed with Bonton and written consent of Bonton is must in this regard before placing the order.	P.O.R



Sr. No.	Product Detail	Specification	Price
127	CB-Main COF-127	Overall Dimensions: Seat : W-1115mm x D-300 mm x Seat Ht- 450mm: Structure Made up of MS cold rolled close annealed 1.6mm thick pedestal MIG welded to press formed MS cold rolled close annealed sheet 95x25x1.0mm thk and MS cold rolled close annealed tube dia 25mm x1.2mm thk. Seat and back made of 18mm thick pre-laminated particle board. Side edges covered with teak wood beading duly polished. Grouted on floor by anchor bolt. Book rack optional below seat. All steel components are epoxy powder coated followed by seven tanks anti corrosion treatment of surface. The overall appearance of the product shall be as per photograph. Note: Floor must be minimum 100mm thick RCC slab to grout the chairs or otherwise written confirmation on deviation should be taken by Bonton, as regard to floor. Steps depth must be as per layout – deviations must be discussed with Bonton and written consent of Bonton is must in this regard before placing the order.	P.O.R

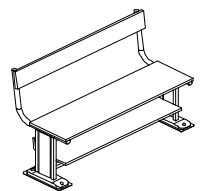

Sr. No.	Product Detail	Specification	Price
128	CB Add-on COF-128	Overall Dimensions: Seat : W1088mm x D-300 mm x Seat Ht :-450mm: Structure Made up of MS cold rolled close annealed 1.6mm thick pedestal MIG welded to press formed MS cold rolled close annealed sheet 95x25x1.0mm thk and MS cold rolled close annealed tube dia 25mm x1.2mm thk. Seat and back made of 18mm thick pre-laminated particle board. Side edges covered with teak wood beading duly polished. Grouted on floor by anchor bolt. Book rack optional below seat. All steel components are epoxy powder coated followed by seven tanks anti corrosion treatment of surface. The overall appearance of the product shall be as per photograph. Note: Floor must be minimum 100mm thick RCC slab to grout the chairs or otherwise written confirmation on deviation should be taken by Bonton, as regard to floor. Steps depth must be as per layout – deviations must be discussed with Bonton and written consent of Bonton is must in this regard before placing the order.	P.O.R

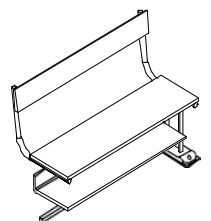

Sr. No.	Product Detail	Specification	Price
129	Podium COF-129	Overall Dimension: W-600mmX D-450mmX H-1260mm: - 200mm wide Leg section made of extruded Aluminum section and MS cold rolled close annealed covers for wire management. Top made up of 18mm the prelaminated partial board with teak wooden edge banded on edges. One edge protruded up, would be of teak wood to hold the paper / books. All metal section powder-coated with min. 45 micron DFT after anti corrosion surface treatment. Appearance of product as per Photograph.	P.O.R



Sr. No.	Product Detail	Specification	Price
130	SS-Racking Main Single Side COF-130	Overall Size:- H:-1980mm, W:-915mm, D:-380mm: Body Structure: Made up of prime quality cold rolled close annealed MS sheet 1.0mm thk 3 fold side panel with dia 9mm hole in middle of each panel throughout the height at 25mm pitch for height adjustability of shelves. Adjustable middle shelf made out of Prime Quality cold rolled close annealed 1.0mm thk. Sheet. Complete knockdown assembly. All steel components are epoxy powder coated followed by seven tanks anti corrosion treatment of surface. Overall appearance as per photograph.	P.O.R



Sr. No.	Product Detail	Specification	Price
131	SS-Racking Add-on Single Side COF-131	Overall Size:- H:-1980mm, W:-915mm, D:-380mm: Body Structure: Made up of prime quality cold rolled close annealed MS sheet 1.0mm thk 3 fold side panel with dia 9mm hole in middle of each panel throughout the height at 25mm pitch for height adjustability of shelves. Adjustable middle shelf made out of Prime Quality cold rolled close annealed 1.0mm thk. Sheet. Complete knockdown assembly. All steel components are epoxy powder coated followed by seven tanks anti corrosion treatment of surface. Overall appearance as per photograph.	P.O.R
132	BS-Racking – Main Both Side COF-132	Overall Size:- H:-1980mm,,W:-915mm D:535mm.: Body Structure: Made up of prime quality cold rolled close annealed MS sheet 1.0mm thk 3 fold side panel with dia 9mm hole in middle of each panel throughout the height at 25mm pitch for height adjustability of shelves. Adjustable middle shelf made out of Prime Quality cold rolled close annealed 1.0mm thk. Sheet. Complete knockdown assembly. All steel components are epoxy powder coated followed by seven tanks anti corrosion treatment of surface. Overall appearance as per photograph.	P.O.R
133	BS-racking Add-on Both Side COF-133	Overall Size:- H:-1980mm,,W:-915mm D:535mm.: Body Structure: Made up of prime quality cold rolled close annealed MS sheet 1.0mm thk 3 fold side panel with dia 9mm hole in middle of each panel throughout the height at 25mm pitch for height adjustability of shelves. Adjustable middle shelf made out of Prime Quality cold rolled close annealed 1.0mm thk. Sheet. Complete knockdown assembly. All steel components are epoxy powder coated followed by seven tanks anti corrosion treatment of surface. Overall appearance as per photograph.	P.O.R
134	Bag Rack- Main COF-134	Overall Size:- H:-1980mm, W:-380mm D:-380mm: Made up of prime quality MS cold rolled close annealed sheet. Shelf – 5 nos making six compartments. All steel components are epoxy powder coated followed by seven tanks anti corrosion treatment of surface. The overall appearance of the product shall be as per photograph.	P.O.R
135	Bag Rack- Add-on COF-135	Overall Size: - H:-1980mm, W:-360mm D: 380mm. Made up of prime quality MS cold rolled close annealed sheet. Shelf – 5 nos making six compartments. All steel components are epoxy powder coated followed by seven tanks anti corrosion treatment of surface. The overall appearance of the product shall be as per photograph.	P.O.R
136	Shoe Rack- Main COF-136	Overall Size:- H:-1075mm,,W:-300mm D:350mm: Made up of prime quality MS cold rolled close annealed sheet. Shelf - 5 nos making six compartments. All steel components are epoxy powder coated followed by seven tanks anti corrosion treatment of surface. The overall appearance of the product shall be as per photograph.	P.O.R
137	Shoe Rack-Add on COF-137	Overall Size:- H:-1075mm, W:-275mm, D:-350mm : Made up of prime quality MS cold rolled close annealed sheet. Shelf - 5 nos making six compartments. All steel components are epoxy powder coated followed by seven tanks anti corrosion treatment of surface. The overall appearance of the product shall be as per photograph.	P.O.R
138	Magazine Rack main COF-138	Size:- Height:1900mm, Width:300mm, Depth:400mm: Sides made of 18mm thick pre-laminated particle board. Edges covered with PVC edge band on through feed edge bending machine. Shelf tray & Bottom Panel made by M.S.cold rolled close annealed Sheet. Tray slides on pvc roller bearing. All steel components are epoxy powder coated followed by seven tanks anti corrosion treatment of surface. The overall appearance of the product shall be as per photograph.	P.O.R

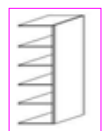
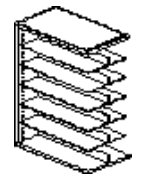
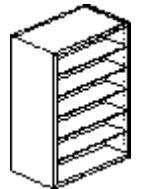
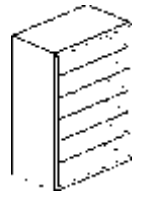

Sr. No.	Product Detail	Specification	Price
139	Magazine Rack Add-on COF-139	Size:- Height:1900mm, Width:283mm, Depth:400mm: Sides made of 18mm thick pre-laminated particle board. Edges covered with PVC edge band on through feed edge bending machine. Shelf tray & Bottom Panel made by M.S.cold rolled close annealed Sheet. Tray slides on pvc roller bearing. All steel components are epoxy powder coated followed by seven tanks anti corrosion treatment of surface. The overall appearance of the product shall be as per photograph.	P.O.R



Sr. No.	Product Detail	Specification	Price
140	News Paper Stand both side COF-140	Size: Width:- 750mm x Depth:- 1000mm x Height:- 1200mm (For 2 News Paper), Frame Structure : Made up of Prime quality cold rolled close annealed Rectangular pipe 25x50x1.2mm thk MIG welded to Press formed steel column 105mm x 25mm x 1.0mm thk. Top made of 18mm thick pre- laminated particle board. Side edges covered with PVC edge band on edge bending machine. All steel components are epoxy powder coated followed by seven tanks anti corrosion treatment of surface. The overall appearance of the product shall be as per photograph.	P.O.R



Sr. No.	Product Detail	Specification	Price
141	News Paper Stand single side COF-141	Size: Width:- 750mm x Depth:- 500mm x Height:- 1200mm (For 1 News Paper), Frame Structure : Made up of Prime quality cold rolled close annealed Rectangular pipe 25x50x1.2mm thk MIG welded to Press formed steel column 105mm x 25mm x 1.0mm thk. Top made of 18mm thick pre- laminated particle board. Side edges covered with PVC edge band on edge bending machine. All steel components are epoxy powder coated followed by seven tanks anti corrosion treatment of surface. The overall appearance of the product shall be as per photograph.	P.O.R



Sr. No.	Product Detail	Specification	Price
142	Book Stopper COF-142	Size: Width: - 168mm x Depth:- 160mm x Height:- 190mm with 1.2mm thick : Made up of Prime quality cold rolled close annealed Press formed sheet. Epoxy powder coated followed by seven tanks anti corrosion treatment of surface. The overall appearance of the product shall be as per photograph.	P.O.R



Sr. No.	Product Detail	Specification	Price
143	Reading Table 7'x3' COF-143	Size:- Length:2100mm, Width:900mm, Height:750mm:- T – Frame made of press formed MS cold rolled close annealed sheet and tubes, MIG/TIG & Spot welding for fabrication. Top made of 18mm thick pre-laminated particle board. Side Edges covered with PVC edge band on edge bending machine. Perforated modesty panel at centre of table. All steel components are epoxy powder coated after seven tanks anti corrosion treatment of surface. The overall appearance of the product shall be as per photograph.	P.O.R



Sr. No.	Product Detail	Specification	Price
144	Reading Table 4.5'x3' COF-144	Size:- Length: 1350mm, Width:900mm, Height:750mm, T – Frame made of press formed MS cold rolled close annealed sheet and tubes, MIG/TIG & Spot welding for fabrication. Top made of 18mm thick pre-laminated particle board. Side Edges covered with PVC edge band on edge bending machine. Perforated modesty panel at centre of table. All steel components are epoxy powder coated after seven tanks anti corrosion treatment of surface. The overall appearance of the product shall be as per photograph.	P.O.R



Sr. No.	Product Detail	Specification	Price
145	Lab Table (7'x3') COF-145	Size:- Length:2100mm, Width: 900mm. Height: 750mm, T – Frame made of press formed MS cold rolled close annealed sheet and tubes, MIG/TIG & Spot welding for fabrication. Top made of 25mm thick pre-laminated particle board. Side Edges covered with PVC edge band on edge bending machine. One self at middle of table height. All steel components are epoxy powder coated after seven tanks anti corrosion treatment of surface. The overall appearance of the product shall be as per photograph.	P.O.R



Sr. No.	Product Detail	Specification	Price
146	Lab Table (4.5'x3') COF-146	Size:- Length:1350mm, Width: 900mm. Height: 750mm, T – Frame made of press formed MS cold rolled close annealed sheet and tubes, MIG/TIG & Spot welding for fabrication. Top made of 25mm thick pre-laminated particle board. Side Edges covered with PVC edge band on edge bending machine. One self at middle of table height. All steel components are epoxy powder coated after seven tanks anti corrosion treatment of surface. The overall appearance of the product shall be as per photograph.	P.O.R



Sr. No.	Product Detail	Specification	Price
147	Lab SDU With Top Shelf COF-147	Size:-Length:1200mm,Width 750mm, Height 1150mm, Storage depth is 560 mm & top overhang by 190mm at front. Body part made-up of prime quality cold rolled close annealed Sheet Use only MIG/TIG & Spot welding for fabrication. Top made of 25mm thick pre-laminated particle board. Side Edges covered with PVC edge band on edge bending machine. One adjustable shelf inside storage and Pre-laminated Particle Board Shelf above Work Top for keeping instruments. Locks Ebco / Doorset cylindrical. All steel components are epoxy powder coated followed by seven tanks anti corrosion treatment of surface. The overall appearance of the product shall be as per photograph.	P.O.R



Sr. No.	Product Detail	Specification	Price
148	Lab SDU COF-148	Size:-Length: 1200mm, Width: - 750mm, Height:-900mm, Storage depth is 560 mm & top overhang by 190mm at front. Body part made-up of prime quality cold rolled close annealed Sheet Use only MIG/TIG & Spot welding for fabrication. Top made of 25mm thick pre-laminated particle board. Side Edges covered with PVC edge band on edge bending machine. One adjustable shelf inside storage. Locks Ebco / Doorset cylindrical. All steel components are epoxy powder coated followed by seven tanks anti corrosion treatment of surface. The overall appearance of the product shall be as per photograph	P.O.R

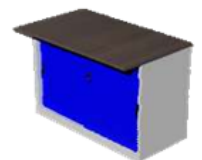

Sr. No.	Product Detail	Specification	Price
149	Chemistry Lab Rack Both Side (Main Unit) COF-149	Size:- Length: 1000mm, Depth:300mm, Height: 600mm. Bottle Rack Structure made up of prime quality MS cold rolled close annealed sheet 20G & 22G thk 3 fold press form side panel with dia 9mm holes in each panel throughout the height at 25mm pitch for adjustability of shelves. All steel components are epoxy powder coated after seven tanks anti corrosion treatment of surface. Powder Coating thk. 50-60 micron	P.O.R

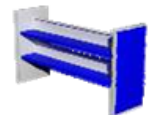

Sr. No.	Product Detail	Specification	Price
150	Chemistry Lab Rack Single Side (Main Unit) COF-150	Size:- Length: 1000mm, Depth:150mm, Height: 600mm. Bottle Rack Structure made up of prime quality MS cold rolled close annealed sheet 20G & 22G thk 3 fold press form side panel with dia 9mm holes in each panel throughout the height at 25mm pitch for adjustability of shelves. All steel components are epoxy powder coated after seven tanks anti corrosion treatment of surface. Powder Coating thk. 50-60 micron	P.O.R



Sr. No.	Product Detail	Specification	Price
151	Drawing Table COF-151	Size: Length: 900, Width:- 600mm, height:- 930mm T – Frame made of press formed and tubular cold rolled close annealed steel sections. Use only MIG/TIG & Spot welding for fabrication. Top made of 18mm thick pre-laminated particle board. Side edges covered with PVC edge band on edge bending machine. Top tilting arrangement for adjustability. Drum Type Leveller for adjusting height. All steel components are epoxy powder coated followed by seven tanks anti corrosion treatment of surface. The overall appearance of the product shall be as per photograph.	P.O.R



Sr. No.	Product Detail	Specification	Price
152	Lab Stool/ Drg. Stool COF-152	Specification: Size:H:710, Seat:H:550, D:300, Under Structure:-Made up of MS cold rolled close annealed, 18G tube. Top made of 18mm thick pre- laminated particle board. Side edges covered with teak wood beading duly polished. All steel components are epoxy powder coated followed by seven tanks anti corrosion treatment of surface. The overall appearance of the product shall be as per photograph.	P.O.R



Sr. No.	Product Detail	Specification	Price
153	Premium Lab Stool COF-153	Overall Size :- Height : 1050mm, Depth: 300mm, Width: 450mm, Base made of chrome plated, MS CRCA single pipe, Seat 12mm thick moulded ply with hand PVC Upholstery.	P.O.R



Sr. No.	Product Detail	Specification	Price
154	Revolving Stool COF-154	Under Structure:-Made up of MS cold rolled close annealed,18G tube cushioned seat and back with 12 mm ply.. All steel components are epoxy powder coated followed by seven tanks anti corrosion treatment of surface. The overall appearance of the product shall be as per photograph.	P.O.R



Sr. No.	Product Detail	Specification	Price
155	Sink table Both Side COF-155	Lab table both side usable of size- W: 600mmxD:1200mmxHt:900mm. The frame made of MS cold rolled close annealed tube, vertical leg made of 25x25x18G(1.2mm), and horizontal tie member made of 25x50x18G(1.2mm). Top made of black granite 17mm thk and black granite supported on fiber cement board 10 mm thk. The door made of press formed cold rolled close annealed sheet fitted with cylindrical hinge with provision to hang the door with frame. The sink made of Ceramic or Stainless steel 1mm thk and tap made of stainless steel. All steel components are epoxy powder coated after seven tanks anti corrosion treatment of surface. Powder coating thk.50-60 micron	P.O.R



Sr. No.	Product Detail	Specification	Price
156	Lab Table With Bottle Rack (Both Side Unit) 1200x1200x900 COF-156	Lab work table with bottle rack both side usable, Size- W:1200mm x D:1200mm x Ht:900mm.The frame made of MS cold rolled close annealed tube, vertical leg made of 25x25x18G(1.2mm), and horizontal tie member made of 25x50x18G(1.2mm). Top made of black granite 17mm thk and black granite supported on fiber cement board 10 mm thk. Bottle Rack Structure over all size: Width- 1000mm x Height- 600mm x Depth-300mm, Made up of prime quality MS cold rolled close annealed sheet 0.8mm thk 3 fold press form side panel with dia 9mm holes in each panel throughout the height at 25mm pitch for adjustability of shelves. Bottom storage over all size-w-1150mm xHt 845mm xD450mm.made up of Prime quality MS cold rolled close annealed sheet 0.8mm thk. One adjustable self creating two compartment. Doors with top hung sliding mechanism, slides on PVC rollers. Lock Ebco/Doorset. Handles die cast PVC. SDU mounted on heavy duty brack castors of superior quality make. Provision for two Gas Burner, one in each side With connection. Light and other arrangements are optional. All steel components are epoxy powder coated followed by seven tanks anti corrosion treatment of surface. Powder coating thk.50-60 micron.	P.O.R



Sr. No.	Product Detail	Specification	Price
157	Lab Table With Bottle Rack (Both Side Unit) 600x1200x900 COF-157	Lab work table with bottle rack both side usable, Size-W:600mmxD:1200mmxHt:900mm.The frame made of MS cold rolled close annealed tube, vertical leg made of 25x25x18G(1.2mm), and horizontal tie member made of 25x50x18G(1.2mm). Top made of black granite 17mm thk and black granite supported on fiber cement board 10 mm thk. Bottle Rack Structure over all size: Width- 500mm x Height- 600mm x Depth-300mm, Made up of prime quality MS cold rolled close annealed sheet 0.8mm thk 3 fold press form side panel with dia 9mm holes in each panel throughout the height at 25mm pitch for adjustability of shelves. Bottom storage over all size-w-550mm xHt 845mm xD450mm.made up of Prime quality MS cold rolled close annealed sheet 0.8mm thk. One adjustable self creating two compartment. Doors with top hung sliding mechanism, slides on PVC rollers. Lock Ebco/Doorset. Handles die cast PVC. SDU mounted on heavy duty brack castors of superior quality make. Provision for two Gas Burner, one in each side With connection. Light and other arrangements are optional. All steel components are epoxy powder coated followed by seven tanks anti corrosion treatment of surface. Powder coating thk.50-60 micron.	P.O.R



Sr. No.	Product Detail	Specification	Price
158	End SDU (for Both Side unit) COF-158	Lab side table of size:-W/L: 1200mmxHt:900mmxD:450mm: Made up of Prime quality MS cold rolled close annealed sheet 0.8mm thk. One adjustable self creating two compartment. Doors with top hung sliding mechanism, slides on PVC rollers. Lock Ebco/Doorset. Handles die cast PVC. SDU mounted on heavy duty brake castors of superior quality make. The top made of black granite 17mm thk and bottom support on fiber cement board 10mm thk. All steel components are epoxy powder coated followed by seven tanks anti corrosion treatment of surface. Powder coating thk 50-60 micron.	P.O.R



Sr. No.	Product Detail	Specification	Price
159	Sink table Single Side COF-159	Lab table one side usable of size- W:600mm x D:600mm x Ht:900mm. The frame made of MS cold rolled close annealed tube, vertical leg made of 25x25x18G(1.2mm), and horizontal tie member made of 25x50x18G(1.2mm). Top made of black granite 17mm thk and black granite supported on fiber cement board 10 mm thk. The door made of press formed cold rolled close annealed sheet fitted with cylindrical hinge with provision to hang the door with frame. The sink made of Ceramic or Stainless steel 1mm thk and tap made of stainless steel. All steel components are epoxy powder coated after seven tanks anti corrosion treatment of surface. Powder coating thk.50-60 micron	P.O.R



Sr. No.	Product Detail	Specification	Price
160	Lab Table With Bottle Rack (Single Side Unit) COF-160	Lab work table with bottle rack single side usable, Size-W:1200mm x D:600mm x Ht:900mm. The frame made of MS cold rolled close annealed tube, vertical leg made of 25x25x18G(1.2mm), and horizontal tie member made of 25x50x18G(1.2mm). Top made of black granite 17mm thk and black granite supported on fiber cement board 10mm thk. Bottle Rack Structure over all size: Width- 1000mm x Height- 600mm x Depth-150mm: Made up of prime quality MS cold rolled close annealed sheet 0.8mm thk 3 fold press form side panel with dia 9mm holes in each panel throughout the height at 25mm pitch for adjustability of shelves. Bottom storage over all size- w-1150mm x Ht 845mm x D450mm.made up of Prime quality MS cold rolled close annealed sheet 0.8mm thk. One adjustable self creating two compartment. Doors with top hung sliding mechanism, slides on PVC rollers. Lock Ebco/Doorset. Handles die cast PVC. SDU mounted on heavy duty brake castors of zipco make. Provision for one Gas Burner with connection. Light and other arrangements are optional. All steel components are epoxy powder coated followed by seven tanks anti corrosion treatment of surface. Powder coating thk.50-60 micron.	P.O.R



Sr. No.	Product Detail	Specification	Price
161	Lab Corner Table COF-161	Size: - W: 600mmxD:600mmxHt:900mm. The frame made of MS cold rolled close annealed tube, vertical leg made of 25x25x18G(1.2mm), and horizontal tie member made of 25x50x18G(1.2mm). Top made of black granite 17mm thk and black granite supported on fiber cement board 10 mm thk. All steel components are epoxy powder coated after seven tanks anti corrosion treatment of surface. Powder coating thk.50-60 micron	P.O.R



Sr. No.	Product Detail	Specification	Price
162	Hostel bed With Storage- COF-162	Size:- length: 1950mm, Width: 900mm, Height:450mm Made out of prime quality cold rolled close annealed sheet & Tubes. Body parts made out of prime quality 0.8mm thk. Press form cold rolled close annealed sheet. Use only MIG/TIG & Spot Welding for fabrication. Provision of drawers as per requirement, drawer move on heavy duty ball bearing type roller channel. Top of the Bed made of 12mm thick plywood. All steel components are epoxy powder coated followed by seven tanks anti corrosion treatment of surface. The overall appearance of the product shall be as per photograph.	P.O.R



Sr. No.	Product Detail	Specification	Price
163	Bunk Bed COF-163	Size:- length:1980mm, Width: 910mm,Sleeping H:450mm,and second person sleeping height:1770mm, Made out of prime quality cold rolled closed annealed sheet & Tubes. Horizontal frame made out of prime quality 1.0mm thick. Press form cold rolled close annealed sheet. Vertical frame made out of prime quality cold rolled closed annealed tube dia 38x1.6mm thick. Only MIG/TIG and spot welding for fabrication. Two storage box of 900Wx800Dx312H provided on bed with proper piano hinges attachment. Top of bed is 18mm thick Ply and box bottom ply is 12mm thick. The metres size will be 1900Lx850Wx100thick for bed. All steel components are epoxy powder coated followed by seven tanks anti corrosion treatment of surface. The overall appearance of the product shall be as per photograph.	P.O.R



Sr. No.	Product Detail	Specification	Price
164	Hostel bed With Storage COF-164	Size: - length: 1950mm, Width: 900mm, Height: 450mm, Made out of prime quality cold rolled close annealed sheet & Tubes. Body parts made out of prime quality 0.8mm thk. Press form cold rolled close annealed sheet. Use only MIG/TIG & Spot Welding for fabrication. One drawer of 3' width and 3' depth provided on wheels attached from Bed with proper attachment. Top of Bed is MS cold rolled close annealed Sheet. All steel components are epoxy powder coated followed by seven tanks anti corrosion treatment of surface. The overall appearance of the product shall be as per photograph.	P.O.R
165	Steel bed COF-165	Size: - length: 1950mm, Width: 900mm, Height: 400mm, Made out of prime quality cold rolled close annealed sheet & Tubes. Body parts made out of prime quality 0.8mm thk. Press form cold rolled close annealed sheet. Use only MIG/TIG & Spot Welding for fabrication. Headrest & footrest made out of 32 round 1.2mmCRCA Tube. Top of Bed is MS cold rolled close annealed Sheet. All steel components are epoxy powder coated followed by seven tanks anti corrosion treatment of surface. The overall appearance of the product shall be as per photograph.	P.O.R
166	Bed Side locker COF-166	Bed side table Length: 450, Width: 450, Height: 550 mm. Body parts made out of prime quality 0.8mm thk. Press form cold rolled close annealed sheet. Use only MIG/TIG & Spot. Top made of 18mm thick pre-laminated particle board. Side Edges covered with PVC edge bend on machine. Drawer Slides on roller slides for free movement. Ebco/ Doorset make locks. Drawer handles would be inbuilt self bended. All steel components are epoxy powder coated followed by seven tanks anti corrosion treatment of surface. The overall appearance of the product shall be as per photograph.	P.O.R
167	BT-Study Table – DX COF-167	Size: - Length: 900mm, Width: 600mm, table top Height 750mm, total height: 1980mm Top made by 18mm thk. Particle board. Body parts made out of prime quality 0.8mm thk. Press form cold rolled close annealed sheet & Tubes. Use only MIG/TIG & Spot welding for fabrication. Dotted embossed steel modesty panel and single drawer provided below table top. Provision made for modular cable duct for electric cables. Soft board & marker board at front. All steel components are epoxy powder coated followed by seven tanks anti corrosion treatment of surface. The overall appearance of the product shall be as per photograph.	P.O.R
168	Hostel Almira COF-168	Size:- height:1980mm, width:910mm depth:550mm, All Body part made-up of prime quality cold rolled close annealed Sheet 0.8mm thick, doors 1mm thick. Use only MIG/TIG & Spot welding for fabrication. Provision of 1 adjustable shelf and 2 Drawer. Three way locking device with six levers superior quality lock for Door. Doors are mounted on pin type MS hinges. All steel components are epoxy powder coated followed by seven tanks anti corrosion pre-treatment of surface. The overall appearance of the product shall be as per photograph.	P.O.R
169	DA-78 COF-169	Size:-height:1980mm, width:910mm depth:550mm, All Body part made-up of prime quality cold rolled close annealed Sheet 0.8mm thick, doors 1mm thick. Use only MIG/TIG & Spot welding for fabrication. Vertically divided into two parts with provision of two separate doors, provided with 1 adjustable shelf and 1 Drawer in each compartment. Three way locking device with six levers superior quality lock for Door. Doors are mounted on pin type MS hinges. All steel components are epoxy powder coated followed by seven tanks anti corrosion treatment of surface. The overall appearance of the product shall be as per photograph.	P.O.R

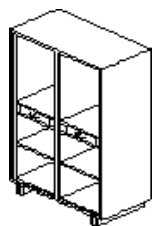
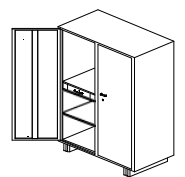
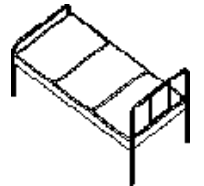

Sr. No.	Product Detail	Specification	Price
170	SA-78 COF-170	Size:-height:1980mm, width:610mm depth:550mm, All Body part made-up of prime quality cold rolled close annealed Sheet 0.8mm thick, doors 1mm thick. Use only MIG/TIG & Spot welding for fabrication. Provision of 1 adjustable shelf and 1 Drawer. Three way locking device with six levers superior quality lock for Door. Doors are mounted on pin type MS hinges. All steel components are epoxy powder coated followed by seven tanks anti corrosion pre-treatment of surface. The overall appearance of the product shall be as per photograph.	P.O.R



Sr. No.	Product Detail	Specification	Price
171	CT-8-SS Canteen Table with S.S. Top 8 seated with foldable Stool COF-171	Size:- L-2130mmx D-915mmxHt-750mm: Under structure made of prime quality cold rolled close annealed square tube 30mm x 30mm x 1.2mm thk. With 8 nos. folding/tilting stools 4 on each side. Stools fitted on specially designed C-clamps over leg rest on each side with Bush for smooth functioning. Top-1.0mm thk. Stainless-steel properly bent & edge-formed, supported with 12mm Ply/PLPB below top. Stool Top made up of 1.0 mm thk. Stainless steel dia 300mm, supported on 12mm Ply/PLPB fitted with CSK screw on 25mmx3 mm thk. MS flat welded on stool frame. All steel components are epoxy powder coated followed by seven tanks anti corrosion treatment of surface. The overall appearance of the product shall be as per photograph.	P.O.R



Sr. No.	Product Detail	Specification	Price
172	CT-4-SS Canteen Table with S.S. Top 4 seated with foldable Stool COF-172	Size: - L-1065 mmx D-915mmxHt-750mm. Under structure made of prime quality cold rolled close annealed square tube 30mm x 30mm x 1.2mm thk. With 4 nos. folding/tilting stools 2 on each side. Stools fitted on specially designed C-clamps over leg rest on each side with Bush for smooth functioning. Top-1.0mm thk. Stainless-steel properly bent & edge-formed, supported with 12mm Ply below top. Stool Top made up of 1.0 mm thk. Stainless steel dia 300mm, supported on 12mm Ply/PLPB fitted with CSK screw on 25mmx3 mm thk. MS flat welded on stool frame. All steel components are epoxy powder coated followed by seven tanks anti corrosion treatment of surface. The overall appearance of the product shall be as per photograph.	P.O.R



Sr. No.	Product Detail	Specification	Price
173	CT-8-SS Top without stool COF-173	Size:- L-2130mmx D-915mmx Ht-750mm Under structure made of prime quality cold rolled close annealed square tube 30mm x 30mm x 1.2mm thk. Both side foot-rests provided in the table. Top-1.0mm thk. Stainless-steel properly bent & edge- formed, supported with 12mm Ply below top. All steel components are epoxy powder coated followed by seven tanks anti corrosion treatment of surface. The overall appearance of the product shall be as per photograph.	P.O.R



Sr. No.	Product Detail	Specification	Price
174	Bench COF-174	Size:- L-2130mmx D-305mmx Ht-450mm Under structure made of prime quality cold rolled close annealed square tube 30mm x 30mm x 1.2mm thk. With foot-rest provided. Bench top-1.0mm thk. Stainless-steel properly bent & edge-formed, supported with 12mm Ply below top. All steel components are epoxy powder coated followed by seven tanks anti corrosion treatment of surface. The overall appearance of the product shall be as per photograph.	P.O.R



Sr. No.	Product Detail	Specification	Price
175	CT-4-SS top without stool COF-175	Overall size: - L-1065mmx D-915mmxHt-750mm. Under structure made of prime quality cold rolled close annealed square tube 30mm x 30mm x 1.2mm thk. Both side foot-rests provided in the table. Top-1.0mm thk. Stainless-steel properly bent & edge- formed, supported with 12mm Ply below top. All steel components are epoxy powder coated followed by seven tanks anti corrosion treatment of surface. The overall appearance of the product shall be as per photograph.	P.O.R



Sr. No.	Product Detail	Specification	Price
176	Bench COF-176	Size:- L-1065mmx D-305mmx Ht-450mm Under structure made of prime quality cold rolled close annealed square tube 30mm x 30mm x 1.2mm thk with foot-rest provided. Bench top-1.0mm thk. Stainless-steel properly bent & edge-formed, supported with 12mm Ply below top. All steel components are epoxy powder coated followed by seven tanks anti corrosion treatment of surface. The overall appearance of the product shall be as per photograph.	P.O.R
177	CTC -2 COF-177	Overall Size : Width :430mm , Depth:558mm , Height: 860mm, Seat Height:475mm : Made of MS CRCA Tube Dia. 25 x 18 gauges with back rest tube of Ø 9.5mm, duly Chrome Plated. Seat made of Ply 12mm With Cushion.	P.O.R
178	Executive Hi Back. COF-178	Size: Height Overall/Seat – Max: 1240/535mm, Min: 1160/455mm, Depth – 625mm, Width- 650mm: 5-Prong nylon base for stability. Twin Wheel heavy Duty Castor for easy mobility under load. Hot pressed ply wood with steel T-Nuts for rigid fastening. Sturdy steel column gas lifts for centre support and seat height adjustment. Telescopic ABS cover over steel column. Lockable centre tilt mechanism and with Single piece die castes PP arm rest. Quality Latherite tapestry with double stitch. High density PU cushion. Over all appearance of product as shown in picture. Available in only Black Latherite.	P.O.R
179	Executive Low Back. COF-179	Size: Height Overall/Seat – Max: 1105/510mm, Min: 1020/440mm, Depth – 660mm, Width- 660mm: 5-Prong nylon base for stability. Twin Wheel heavy Duty Castor for easy mobility under load. Hot pressed ply wood with steel T-Nuts for rigid fastening. Sturdy steel column gas lifts for centre support and seat height adjustment. Telescopic ABS cover over steel column. Lockable centre tilt mechanism and with Single piece die castes PP arm rest. Quality Latherite tapestry with double stitch. High density PU cushion. Over all appearance of product as shown in picture. Available in only Black Latherite.	P.O.R
180	Executive Visitor Chair COF-180	Size: Height Overall/Seat – Max: 1105/510mm, Min: 1020/440mm, Depth – 660mm, Width- 660mm: 5- Prong nylon base for stability. Twin Wheel heavy Duty Castor for easy mobility under load. Hot pressed ply wood with steel T-Nuts for rigid fastening. Sturdy steel column gas lifts for center support and seat height adjustment. Telescopic ABS cover over steel column. Lockable center tilt mechanism and with Single piece die castes PP arm rest. Quality Latherite tapestry with double stitch. High density PU cushion. Overall appearance of product as shown in picture. Available in only Black Latherite.	P.O.R
181	UE High back COF-181	Size: Height Overall/Seat – Max: 1240/535mm, Min: 1160/455mm, Depth – 625mm, Width- 650mm: 5-Prong nylon base for stability. Twin Wheel heavy Duty Castor for easy mobility under load. Hot pressed ply wood with steel T-Nuts for rigid fastening. Sturdy steel column gas lifts for centre support and seat height adjustment. Telescopic ABS cover over steel column. Lockable centre tilt mechanism and with Single piece die castes PP arm rest. Quality Latherite tapestry with double stitch. High density PU cushion. Overall appearance of product as shown in picture. Available in only Black Latherite.	P.O.R
182	UE Low Back COF-182	Size: Height Overall/Seat – Max: 1105/510mm, Min: 1020/440mm, Depth – 660mm, Width- 660mm: 5-Prong nylon base for stability. Twin Wheel heavy Duty Castor for easy mobility under load. Hot pressed ply wood with steel T-Nuts for rigid fastening. Sturdy steel column gas lifts for centre support and seat height adjustment. Telescopic ABS cover over steel column. Lockable centre tilt mechanism and with Single piece die castes PP arm rest. Quality Latherite tapestry with double stitch. High density PU cushion. Overall appearance of product as shown in picture. Available in only Black Latherite.	P.O.R

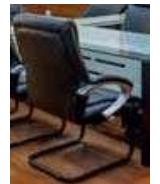

Sr. No.	Product Detail	Specification	Price
183	U.E.Visitor COF-183	Size: Height Overall/Seat - 1080/480mm, Depth - 630mm, Width- 660mm: Under Structure cantilever type MS cold rolled close annealed Tube 1.6 mm thick. Hot pressed ply wood with steel T- Nuts for rigid fastening. Single piece die castes PP arm rest. Quality Latherite tapestry with double stitch. High density PU cushion. All steel components should be epoxy powder coated followed by seven tanks anti corrosion treatment of surface. The overall appearance of the product shall be as per photograph. Available in only Black Latherite.	P.O.R



Sr. No.	Product Detail	Specification	Price
184	Chair Ergo HI-back COF-184	Size: Total Height-1050-1150mm, Depth 600mm, Width-535mm Seat Height: 420-520mm. 5-Prong nylon base for stability. Twin Wheel heavy Duty Castor for easy mobility under load. Hot pressed ply wood with steel T-Nuts for rigid fastening. Sturdy steel column gas lifts for centre support and seat height adjustment. Telescopic ABS cover over steel column. Lockable centre tilt mechanism and with Single piece integral skin PU arm rest. Quality tapestry with PVC beading all around. High density Moulded PU cushion. Upholstery 2.0 Mtr Overall appearance of product as shown in picture.	P.O.R



Sr. No.	Product Detail	Specification	Price
185	Chair Ergo Low back COF-185	Size: Total Height: 830-930mm, Depth: 600mm, Width: 550mm Seat Height: 450-550mm. 5-Prong nylon base for stability. Twin Wheel heavy Duty Castor for easy mobility under load. Hot pressed ply wood with steel T-Nuts for rigid fastening. Sturdy steel column gas lifts for centre support and seat height adjustment. Telescopic ABS cover over steel column. Lockable centre tilt mechanism and with Single piece integral skin PU arm rest. Quality tapestry with PVC beading all around. High density Moulded PU cushion. Upholstery 1.5 Mtr Over all appearance of product as shown in picture.	P.O.R



Sr. No.	Product Detail	Specification	Price
186	Chair Ergo Visitor COF-186	Size: Total Height-850mm, Depth 570mm, Width-550mm Seat Height: 440mm. Under Structure cantilever type MS cold rolled close annealed Tube 1.6 mm thick. Hot pressed ply wood with steel T-Nuts for rigid fastening. Single piece integral skin PU arm rest. Quality tapestry. High density PU moulded cushion. All steel components are epoxy powder coated followed by seven tanks anti corrosion treatment of surface. Upholstery 1.5 Mtr The overall appearance of the product shall be as per photograph.	P.O.R



Sr. No.	Product Detail	Specification	Price
187	Chair Premium Ergo HI-back COF-187	Size: Total Height-1070-1190mm, Depth 685mm, Width-590mm Seat Height: 425-510mm. 5-Prong nylon base for stability. Twin Wheel heavy Duty Castor for easy mobility under load. Hot pressed ply wood with steel T-Nuts for rigid fastening. Seat and back are covered with PP cover. Sturdy steel column gas lifts for centre support and seat height adjustment. Telescopic ABS cover over steel column. Lockable centre tilt mechanism and with Single piece integral skin PU arm rest. Quality tapestry. High density Moulded PU cushion. Upholstery 1.5 Mtr. Over all appearance of product as shown in picture.	P.O.R



Sr. No.	Product Detail	Specification	Price
188	Chair Premium Ergo Low back COF-188	Size: Total Height-810-895mm, Depth 685mm, Width-555mm Seat Height: 425-510mm. 5-Prong nylon base for stability. Twin Wheel heavy Duty Castor for easy mobility under load. Hot pressed ply wood with steel T-Nuts for rigid fastening. Seat and back are covered with PP cover. Sturdy steel column gas lifts for centre support and seat height adjustment. Telescopic ABS cover over steel column. Lockable centre tilt mechanism and with Single piece integral skin PU arm rest. Quality tapestry. High density Moulded PU cushion. Upholstery 1.2 Mtr. Over all appearance of product as shown in picture.	P.O.R



Sr. No.	Product Detail	Specification	Price
189	Chair Premium Ergo Visitor COF-189	Size: Total Height-840mm, Depth 600mm, Width-575mm Seat Height: 450mm. Under Structure cantilever type MS cold rolled close annealed Tube 1.6 mm thick. Hot pressed ply wood with steel T-Nuts for rigid fastening. Single piece integral skin PU arm rest. Quality tapestry. Seat and back covered with PP covers. High density PU moulded cushion. All steel components are epoxy powder coated followed by seven tanks anti corrosion treatment of surface. Upholstery 1.2 Mtr The overall appearance of the product shall be as per photograph.	P.O.R



Sr. No.	Product Detail	Specification	Price
190	Chair Rudy – L COF-190	Size: Over all H: 1000-1100mm, Seat H: 460-560mm, D: 625mm, W: 580mm, 5-Prong nylon base for stability. Twin Wheel heavy Duty Castor for easy mobility under load. Hot pressed ply wood with steel T-Nuts for rigid fastening. Seat and back are covered with PP cover. Sturdy steel column gas lift for centre support and seat height adjustment. Telescopic ABS cover over steel column. Lockable centre tilt mechanism and with Single piece Die castes PP arm rest. Quality tapestry. High density Moulded PU cushion. Upholstery 0.85 Mtr. Over all appearance of product as shown in picture	P.O.R



Sr. No.	Product Detail	Specification	Price
191	Chair Rudy - M COF-191	Size:- H: 910-1010mm, Seat H: 470-570mm, D: 575mm, W: 580mm : 5-Prong nylon base for stability. Twin Wheel heavy Duty Castor for easy mobility under load. Hot pressed ply wood with steel T-Nuts for rigid fastening. Seat and back are covered with PP cover. Sturdy steel column gas lifts for centre support and seat height adjustment. Telescopic ABS cover over steel column. Lockable centre tilt mechanism and with Single piece Die castes PP arm rest. Quality tapestry. High density Moulded PU cushion. Tapestry 0.75 Mtr. Overall appearance of product as shown in picture.	P.O.R



Sr. No.	Product Detail	Specification	Price
192	Revolving Chair Rudy - Small COF-192	Size:- H: 785-885mm, Seat H: 390-470mm, D: 480mm, W: 550mm : 5-Prong nylon base for stability. Twin Wheel heavy Duty Castor for easy mobility under load. Hot pressed ply wood with steel T-Nuts for rigid fastening. Seat and back are covered with PP cover. Sturdy steel column gas lifts for centre support and seat height adjustment. Telescopic ABS cover over steel column. Lockable centre tilt mechanism and with Single piece Die castes PP arm rest. Quality tapestry. High density Moulded PU cushion. Tapestry 0.75 Mtr. Overall appearance of product as shown in picture.	P.O.R



Sr. No.	Product Detail	Specification	Price
193	Mesh High back Chair COF-193	Size- H: 1230-1330mm, Seat H: 500-600mm, D-550mm, W-630mm. 5-Prong nylon base for stability. Twin Wheel heavy Duty Castor for easy mobility under load. Seat Hot pressed ply wood with steel T-Nuts for rigid fastening with PP cover. Back is glass filled Nylon fitted with Mesh Cloth. Sturdy steel column gas lift for centre support and seat height adjustment. Telescopic ABS cover over steel column. Five position Lockable synchrony tilt mechanism, with Single piece die castes PP arm rest adjustable with PU pad. Quality tapestry. High density Moulded PU cushion. Upholstery 0.85 Mtr. Overall appearance of product as shown in picture.	P.O.R



Sr. No.	Product Detail	Specification	Price
194	Mesh Low Back Chair COF-194	Specification-Size-H: 1000-1100mm, Seat ht: 460-560mm, D-600mm, W-590 mm. 5-Prong nylon base for stability. Twin Wheel heavy Duty Castor for easy mobility under load. Seat Hot pressed ply wood with steel T-Nuts for rigid fastening with PP cover. Back is moulded Bright Bar with stitched Mesh Cloth. Sturdy steel column gas lifts for centre support and seat height adjustment. Telescopic ABS cover over steel column. Lockable synchrony tilts mechanism and with Single piece Die castes PP arm rest adjustable with PP pad. Quality tapestry. High density Moulded PU cushion. Upholstery 0.50 Mtr. Overall appearance of product as shown in picture.	P.O.R



Sr. No.	Product Detail	Specification	Price
195	Chair Mona With Handle COF-195	Size: Total Height - 760-860mm, Depth- 525mm & Width 440 Seat Height: 390-480. 5-Prong nylon base for stability. Twin Wheel heavy Duty Castor for easy mobility under load. Hot pressed ply wood with steel T-Nuts for rigid fastening. Seat and back are covered with PP cover. Sturdy steel column gas lifts for centre support and seat height adjustment. Telescopic ABS cover over steel column. Back connected with Steel tube. Single piece Die castes PP arm rest. Quality tapestry. High density Moulded PU cushion. Upholstery 0.75 Mtr. Overall appearance of product as shown in picture.	P.O.R



Sr. No.	Product Detail	Specification	Price
196	Chair Mona Without Handle COF-196	Size: Total Height – 760-860mm, Depth- 525mm & Width 440 Seat Height: 390-480. 5-Prong nylon base for stability. Twin Wheel heavy Duty Castor for easy mobility under load. Hot pressed ply wood with steel T-Nuts for rigid fastening. Seat and back are covered with PP cover. Sturdy steel column gas lift for centre support and seat height adjustment. Telescopic ABS cover over steel column. Back connected with Steel tube. Quality tapestry. High density Moulded PU cushion. Upholstery 0.75 Mtr. Overall appearance of product as shown in picture.	P.O.R



Sr. No.	Product Detail	Specification	Price
197	Class Room Chair- Wooden shell COF-197	Size: Total Height-860mm, Width 400mm, Depth-500mm, Seat Height-450mm Under structure made out of MS cold rolled close annealed tube 19mmx1.25mm thick. Fitted with 12 mm thick 11 ply moulded ply wood shell. Steel components are epoxy powder coated followed by seven tanks anti corrosion pre-treatment of surface. Or Chrome plated.	P.O.R



Sr. No.	Product Detail	Specification	Price
198	Computer Chair Wooden Shell with cushion COF-198	Size: Total H - 820/920, W - 430, D - 600, Seat H - 400/500 Wooden Shell 12mm thick made of 11 core moulded ply fitted on 2mm Press formed MS plate with lever to operate gas pump. Sturdy steel column gases lift for centre support and seat height adjustment. Telescopic ABS cover over steel column. 5- Prong, nylon- base for stability. Twin- wheel heavy-duty castors to provide easy mobility under load. Overall appearance of Chair as per photograph.	P.O.R



Sr. No.	Product Detail	Specification	Price
199	Chair N-Type With Handle COF-199	Size: Overall Height - 860mm, Depth - 480mm & Width 600mm. Under Structure made of 25mm dia MS cold rolled close annealed tube 1.2 mm thick, duly powder coated after anti corrosion treatment of surface. Fitted with moulded PU arm rest. Seat and back are made of 12mm thick Hot pressed ply wood with high density PU foam, upholstered with fine quality fabric. Steel components are epoxy powder coated followed by seven tanks anti corrosion pre-treatment of surface. Upholstery 0.75 Mtr. Overall appearance as per photograph.	P.O.R



Sr. No.	Product Detail	Specification	Price
200	Chair N-Type Without Handle COF-200	Size: Total Height – 860mm, Depth – 550mm & Width 440mm: Under Structure made of 19mm dia MS cold rolled close annealed tube 1.2 mm thick, duly powder coated after anti corrosion treatment of surface. Seat and back are made of 12mm thick Hot pressed ply wood with high density PU foam, upholstered with fine quality fabric. Steel components are epoxy powder coated followed by seven tanks anti corrosion pre-treatment of surface. Upholstery 0.75 Mtr. Overall appearance as per photograph.	P.O.R



Sr. No.	Product Detail	Specification	Price
201	Chair Scandy COF-201	Size:-Overall H: 830mm, Seat h: 460mm, D: 580mm, W: 535mm: Under Structure made of 19mm dia MS cold rolled close annealed tube 1.2 mm thick, duly powder coated after anti corrosion treatment of surface. Seat and back are made of 12mm thick Hot pressed ply wood with high density PU foam, upholstered with fine quality fabric. Arms Tubular. Steel components are epoxy powder coated followed by seven tanks anti corrosion pre-treatment of surface. Upholstery 0.6 Mtr. Overall appearance as per photograph.	P.O.R



Sr. No.	Product Detail	Specification	Price
202	Chair Prisma Without Handle COF-202	Size:-Overall H: 830mm, Seat h: 460mm,D: 530mm,W: 560mm: Back polypropylene material. Seat cut foam with tapestry. Frame oval tube 13x31-16 Gauge, Under Structure made of MS cold rolled close annealed capsule pipe frame 1.2 mm thick, duly powder coated after anti corrosion treatment of surface. Seat are made of 12mm thick Hot pressed ply wood with high density PU foam, Back rest –PP seat with upholstered with fine quality fabric. With powder coated.	P.O.R
203	Chair Scandy Mesh COF-203	Size:-Overall H: 900mm,Seat h: 460mm,D: 580mm,W: 535mm: Under Structure made of 19mm dia MS cold rolled close annealed tube 1.2 mm thick, duly powder coated after anti corrosion treatment of surface. Seat is made of 12mm thick Hot pressed ply wood with high density PU foam, upholstered with fine quality fabric. Back made of MS moulded Bar fitted with Nylon mesh. Arms Tubular. Steel components are epoxy powder coated followed by seven tanks anti corrosion pre-treatment of surface. Upholstery 0.4 Mtr. Overall appearance as per photograph.	P.O.R
204	SA Cane COF-204	Size: Height: 890mm, Depth: 560mm Width: 530mm: Under structure made of 1"x16gauge MS cold rolled close annealed tube with insert bent at appropriate angle for seating comfort. Seat and back made of 22mm teak wood, canned with 2 mm half round plastics-cane. Armrests are PU types. Steel components are epoxy powder coated followed by seven tanks anti corrosion pre-treatment of surface. Overall appearance as per Photograph.	P.O.R
205	SWA-CANE COF-205	Size: Height: 880mm, Depth: 560mm Width: 450mm: Under structure made of 1"x16gauge MS cold rolled close annealed tube with insert bent at appropriate angle for seating comfort. Seat and back made of 25mm teak wood, canned with 2 mm half round plastics-cane. Steel components are epoxy powder coated followed by seven tanks anti corrosion pre-treatment of surface. Overall appearance as per Photograph.	P.O.R
206	Chair Slick without arm COF-206	Size: W-410mm, D-530mm, Seat Height-450mm, Total Height-790mm: Under structure made of 19mm dia, 1.2 mm thick MS cold rolled close annealed tube moulded as per design, Seat & back made of hot press ply 12mm thick 11 core veneers faced moulded plywood. Ply fitted to structure with steel inserts with fasteners. All steel components are epoxy powder coated followed by seven tanks anti corrosion treatment of surface. Overall appearance as per Photograph.	P.O.R
207	Chair Visch-PS -A (With arm) COF-207	SIZE: Height: 810mm, Depth: 570mm, Width: 505mm: Perforated Steel Seat and back fixed through neat welding with MS cold rolled close annealed tube structure 1.2 mm thick with Arms. All steel components are epoxy powder coated followed by seven tanks anti corrosion treatment of surface. Overall appearance as per Photograph.	P.O.R
208	Chair Visch-PS – WA (without arm) COF-208	SIZE: Height: 810mm, Depth: 570mm, Width: 445mm: Perforated Steel Seat and back fixed through neat welding with MS cold rolled close annealed tube structure 1.2 mm thick. All steel components are epoxy powder coated followed by seven tanks anti corrosion treatment of surface. Over all appearance as per Photograph.	P.O.R
209	Visben-PS 3 sitter	Over all sizes- 1700mm X 620mm X 850mm (L X W X H). 3- Seater visitor bench with 3 individual seats of 450 mm. width. Perforated steel seat and back will be fixed into individual steel frames, mounted on steel- pedestal. Thickness of perforated steel seat & back 1.0 mm. The individual seat frames will be made of steel pipe of dia 19 mm.The back will be properly curved for back- support. The Seat will have water- fall curve on the front. Handles (6 Nos) will be made of oval- section pipe of size 35 X 10 mm and suitably	P.O.R



	COF-209	curved for proper arm- support. The Pedestal- beam will be made of rectangular steel pipe of Size- 75 x 35 mm.x18G. The mounting brackets for fixing seats will be of 3mm. thickness. The Pedestal beam will rest on two side pillars made of round steel pipe of size- 50 mm dia. The open- ends of the pipes will be covered& finished. All joints will be properly welded & finished. The whole structures including seats are powder- coated. Appearance as per attached photograph.	
--	---------	------------------------------------------------------------------------------------------------------------------------------------------------------------------------------------------------------------------------------------------------------------------------------------------------------------------------------------------------------------------------------------------------------------------------------------------------------------------------------------------	--

Sr. No.	Product Detail	Specification	Price
210	Visben-PS 2 sitter COF-210	Over all sizes- 1115mm X 620mm X 850mm (L X W X H). 2- Seater visitor bench with 2 individual seats of 450 mm. width. Perforated steel seat and back will be fixed into individual steel frames, mounted on steel- pedestal. Thickness of perforated steel seat & back 1.0 mm. The individual seat frames will be made of steel pipe of dia 19 mm. The back will be properly curved for back- support. The Seat will have water- fall curve on the front. Handles (4 Nos) will be made of oval- section pipe of size 35 X 10 mm and suitably curved for proper arm- support. The Pedestal- beam will be made of rectangular steel pipe of Size- 75 x 35 mm.x18G. The mounting brackets for fixing seats will be of 3mm. thickness. The Pedestal beam will rest on two side pillars made of round steel pipe of size- 50 mm dia. The open- ends of the pipes will be covered& finished. All joints will be properly welded & finished. The whole structures including seats are powder- coated. Appearance as per photograph.	P.O.R



Sr. No.	Product Detail	Specification	Price
211	Premium Visitor Chair 3 Seater COF-21	Size: Total length: 1800mm, Total Height: 750 mm, Total Depth: 630 mm and Seat height: 410mm. Made of MS cold rolled close annealed press formed Sheet components duly seamless welded to get proper finish. Chrome plated Handles & BASE. Steel perforated MS moulded one piece seat and back fitted in moulded chrome plated side strips. Three individual seats fitted on MS tube support of 75mm x 35mm. seat and bottom support are Powder coated. Over all appearance as per Photograph.	P.O.R



Sr. No.	Product Detail	Specification	Price
212	Premium Visitor Chair 2 Seater COF-212	Size: Total length: 1200mm, Total Height: 750 mm, Total Depth: 630 mm and Seat height: 410mm. Made of MS cold rolled close annealed press formed Sheet components duly seamless welded to get proper finish. Chrome plated Handles & BASE. Steel perforated MS moulded one piece seat and back fitted in moulded chrome plated side strips. Three individual seats fitted on MS tube support of 75mm x 35mm. seat and bottom support are Powder coated. Over all appearance as per Photograph.	P.O.R



Sr. No.	Product Detail	Specification	Price
213	Chair Scandy Tablet (Half Tablet) COF- 213	Size: Height: 830mm, Seat height: 460mm, Tablet Height: 665mm, Depth: 580mm, Width: 535mm. Under Structure made of 18mm dia 1.2mm thick MS cold rolled close annealed tube, fitted with Upholstered seat and back made from 12mm Hot press ply with high density foam. Tablet made of 18mm thick Pre-laminated Particle Board. Tapestry 0.6 Mtr Overall appearance of Chair as shown in picture.	P.O.R



Sr. No.	Product Detail	Specification	Price
214	Chair Scandy Tablet (Full Tablet) COF- 214	Size: Height: 830mm, Seat height: 460mm, Tablet Height: 665mm, Depth: 580mm, Width: 535mm. Under Structure made of 18mm dia 1.2mm thick MS cold rolled close annealed tube, fitted with Upholstered seat and back made from 12mm Hot press ply with high density foam. Tablet made of 18mm thick Pre-laminated Particle Board. Tapestry - 0.6 Mtr Overall appearance of Chair as shown in picture.	P.O.R



Sr. No.	Product Detail	Specification	Price
215	Chair Ergo-Tab With (Full Tablet) COF-215	Size: Total Height-850mm, Seat Height: 440mm, Tablet Height: 665mm, Depth 270mm & Width: 550mm. Under Structure cantilever type MS cold rolled close annealed Tube 1.6 mm thick. Hot pressed ply wood with steel T-Nuts for rigid fastening. Single piece integral skin PU arm rest. Quality tapestry. High density PU moulded cushion. Book rack made of plastic coated wire mesh fitted at bottom of seat and tablet made of 18mm thick Pre-laminated Particle Board. All steel components are epoxy powder coated followed by seven tanks anti corrosion treatment of surface. Upholstery 1.5 Meter The overall appearance of the product shall be as per photograph.	P.O.R



Sr. No.	Product Detail	Specification	Price
216	Chair Ergo-Tab (With Half Tablet) COF-216	Size: Total Height-850mm, Seat Height: 440mm, Tablet Height: 665mm, Depth 600mm & Width: 550mm. Under Structure cantilever type MS cold rolled close annealed Tube 1.6 mm thick. Hot pressed ply wood with steel T-Nuts for rigid fastening. Single piece integral skin PU arm rest. Quality tapestry. High density PU moulded cushion. Book rack made of plastic coated wire mesh fitted at bottom of seat and tablet made of 18mm thick Pre-laminated Particle Board. All steel components are epoxy powder coated followed by seven tanks anti corrosion treatment of surface. Upholstery 1.5 Meter The overall appearance of the product shall be as per photograph.	P.O.R
217	Wooden Shell Chair-With tablet COF-217	Size-Total ht-860mm, Seat ht-450mm, Tablet ht-680mm, Depth-500mm, Width-480mm. Tubular Under Structure made by dia 19 mm x 18g MS cold rolled close annealed round tube. Frame is powder coated after seven tank surface treatment or chrome plated fitted with Moulded ply wood 12mm/11 ply hot press veneer faced in required design. Tablet also in same material and finish as shell. Overall appearance as per photograph.	P.O.R
218	Steel Perforated Chair with Pedestal COF-218	520mm wide steel perforated steel seat & back of thickness 1.20 mm thick. Mounded in steel tubular Structure as shown in picture. Mounted on Steel Pedestal of 75 mm Ø, 1.25mm thickness .Mounted on Press formed MS cold rolled close annealed Leg of 1.6 mm thickness, top Bracket also made of MS cold rolled close annealed Press formed Part on which seat is duly Mounted –every individual Chair Mounted on Common handle. Overall appearance of Product as shown in picture. Note: Floor must be minimum 100mm thick RCC slab to grout the chairs or otherwise written confirmation on deviation should be taken by Bonton, as regard to floor. Steps depth must be as per layout – deviations must be discussed with Bonton and written consent of Bonton is must in this regard before placing the order.	P.O.R
219	Ergo with Pedestal (LBF) Without Tablet COF-219	Centre to centre distance 530mm.Size: Height: 850mm, Seat Height: 470mm, Depth: 560mm & Width: 560mm. Under Structure made of 75mm dia 1.2mm thick MS cold rolled close annealed tube welded to MS cold rolled close annealed 1.6mm press formed pedestal for better grip and with provision to be grouted at floor. Upholstered seat and back made of Hot pressed ply wood with steel T-Nuts for rigid fastening. Single piece integral skin PU arm rest common for every alternate Chair. Quality tapestry. High density PU moulded cushion. All steel components are epoxy powder coated followed by seven tanks anti corrosion treatment of surface. The overall appearances of the product are as per photograph. Upholstery 1.5 Mtr Note: Floor must be minimum 100mm thick RCC slab to grout the chairs or otherwise written confirmation on deviation should be taken by Bonton, as regard to floor. Steps depth must be as per layout – deviations must be discussed with Bonton and written consent of Bonton is must in this regard before placing the order.	P.O.R
220	Ergo with Pedestal (LBF) with Half Tablet COF-220	Centre to centre distance 560mm.Size: Height: 850mm, Seat Height: 470mm, Depth: 560mm & Width: 610mm. Under Structure made of 75mm dia 1.2mm thick MS cold rolled close annealed tube welded to MS cold rolled close annealed 1.6mm press formed pedestal for better grip and with provision to be grouted at floor. Upholstered seat and back made of Hot pressed ply wood with steel T-Nuts for rigid fastening. Arm rest made of teak wood fitted on MS cold rolled close annealed sheet box and press formed rotating lever specially design to accommodate writing tablet. Quality tapestry. High density PU moulded cushion. Writing tablet made of 18mm thick Pre-laminated Particle Board. All steel components are epoxy powder coated followed by seven tanks anti corrosion treatment of surface. The overall appearances of the product are as per photograph. Upholstery 1.5 Mtr Note: Floor must be minimum 100mm thick RCC slab to grout the chairs or otherwise written confirmation on deviation should be taken by Bonton, as regard to floor. Steps depth must be as per layout – deviations must be discussed with Bonton and written consent of Bonton is must in this regard before placing the order.	P.O.R



Sr. No.	Product Detail	Specification	Price
221	Champion Fixed with Stunner tray COF-221	Centre to centre distance 560mm. Size: Total Height: 980mm, Seat Height: 460mm, Depth: 800mm, Width: 560mm. Fixed Backrest Auto tip up cushion. Seat sizes available from CTC 21" to 24" 2mm thick PP injection moulded cushion and 3mm back cover. Cushion housing with acoustical perforation. Armrest PPCP with cup-holder duly injection moulded / PU waterfall Armrest / Polished wooden Armrest. Fix chair with auto tip up feature. PPCP injection moulded housing for cushion & backrest. Moulded flame resistant & CFC free PU foam. Integral skin moulded armrest/PPCP cup holder Enough thigh and backrest support with wider seating area. All exposed sheet metal parts are powder coated. All fasteners are zinc coated. Usage of anchor-fasteners with high bonding grouting material. Chair structure is made In combination of erw pipe & sheet metal. Back/cushion is made up of polyurethane foam (P.U.) with density of 50±5 kg/m. Side light arrangement on aisle seats for easy traceability of rows/seats . Seat sr. Numbering on chair cushion & backrest. Cloth-60" W-1.15 Mtr.	P.O.R



Champion

Sr. No.	Product Detail	Specification	Price
222	Audi. Chair- Champion COF-222	Centre to centre distance 560mm. Size: Total Height: 980mm, Seat Height: 460mm, Depth: 800mm, Width: 560mm. Fixed Backrest Auto tip up cushion. Seat sizes available from CTC 21" to 24" 5mm thick PP injection moulded cushion and 3mm back cover. Cushion housing with acoustical perforation. Armrest PPCP with cup-holder duly injection moulded / PU waterfall Armrest / Polished wooden Armrest. Fix chair with auto tip up feature. PPCP injection moulded housing for cushion & backrest. Moulded flame resistant & CFC free PU foam. Integral skin moulded armrest/PPCP cup holder Enough thigh and backrest support with wider seating area. All exposed sheet metal parts are powder coated. All fasteners are zinc coated. Usage of anchor-fasteners with high bonding grouting material. Chair structure is made In combination of erw pipe & sheet metal. Back/cushion is made up of polyurethane foam (P.U.) with density of 50±5 kg/m. Side light arrangement on aisle seats for easy traceability of rows/seats . Seat sr. Numbering on chair cushion & backrest. Cloth-60" W-1.15 Mtr.	P.O.R



Champion

Sr. No.	Product Detail	Specification	Price
223	Audi Scholar With Writing Pad COF-223	Centre to centre distance 560mm. Size: Total Height: 1050mm, Seat Height: 460mm, tablet H-570, Depth: 750mm (Normal), After push back 925mm, with tablet 1025mm, Width: 560mm. Push Back reclining / Fixed Back rest. Auto tip up cushion. Seat sizes available from Centre to Centre 21" to 24" PP injection moulded cushion and back cover. Cushion housing with acoustical perforation Armrest polished wooden / PU Wooden writing tablet with black membrane polish / laminated. Pushback/with fixed auto tip up feature. PPCP injection moulded housing for cushion & backrest. Moulded flame resistant & CFC free PU foam. Integral skin moulded armrest with cup holder. Enough thigh and backrest support with wider seating area. All exposed sheet metal parts are powder coated. All fasteners are zinc coated. Usage of anchor-fasteners with high bonding grouting material. Seat sr. Numbering on chair cushion. Chair structure is made In combination of erw pipe & sheet metal. Back/cushion is made up of polyurethane foam (P.U.) with density of 50±5 kg/m. Cloth-60" W-1.20Mtr.	P.O.R



Audi Scholar

Sr. No.	Product Detail	Specification	Price
224	Stunner Push Back COF-224	Centre to centre distance 560mm. Size: Total Height: 1050mm, Seat Height: 460mm, Depth: 750mm (Normal), After Push back 925mm, Width: 560mm. Push back reclining fixed back rest Auto tip up cushion. Seat sizes available from 21 to 24" PP injection moulded cushion and back cover. Cushion housing with acoustical perforation. Armrest PPCP with cup-holder duly injection moulded and OR fabric upholstered PU form insert at hand resting portion, Push back with/ fixed with auto tip up. PPCP injection moulded housing for back & seat cushion. Moulded flame resistance & CFC free PU foam-density of 50 ± 5kg/m. Enough thigh and backrest support with wider seating area. All exposed sheet metal parts are powder coated. All fasteners are zinc coated. Usage of anchor-fasteners with high bonding grouting material. Chair structure is made in combination of erw pipe & sheet metal. Sidelight arrangement on aisle side for easy traceability of rows/seats. Seat sr. Numbering on chair cushion. Cloth-60" W-1.30 Mtr.	P.O.R



Sr. No.	Product Detail	Specification	Price
225	Leisure Push Back COF-225	Centre to centre distance 560mm. Size: Total Height: 1050mm, Seat Height: 460mm, Depth: 750mm (Normal), After Push back 925mm, Width: 560mm. Push Back reclining/Axed Backrest Auto tip up cushion. Seat sizes available from 21" to 24". PP injection moulded cushion and back cover. Cushion housing with acoustical perforation Armrest with integral cup-holder duly injection moulded, with an integral skinned PU Form moulded QR fabric upholstered PU form insert at hand resting portion / PU waterfall Armrest. Pushback with auto tip up feature. PPCP injection moulded housing for cushion & backrest. Moulded flame resistant & CFC free PU foam. Integral skin moulded armrest with cup holder. Enough thigh and backrest support with wider seating area. All exposed sheet metal parts are powder coated. All fasteners are zinc coated. Usage of anchor-fasteners with high bonding grouting material. Seat sr. Numbering on chair cushion. Chair structure is made In combination of erw pipe & sheet metal. Back/cushion is made up of polyurethane foam {P.U.} with density of 50±5 kg/m. Cloth-60" W-1.20 Mtr.	P.O.R



Sr. No.	Product Detail	Specification	Price
226	Cine Deluxe With Head Rest COF-226	Centre to centre distance 560mm. Size: Height: 1050mm, Seat Height: 470mm, Depth: 750mm (Normal), After Push back 925mm & Width: 560mm. Push back reclining with wider headrest. Auto tip up cushion. Seat sizes available from CTC 21" to 24" PP injection moulded cushion and back cover. Cushion housing with acoustical perforation Armrest with integral cup-holder duly injection moulded and with an integral skinned PU Form moulded OR fabric upholstered PU form insert at hand resting portion. Pushback with auto tip up feature. PPCP injection moulded housing for cushion & backrest. Moulded flame resistant & CFC free PU foam. Integral skin moulded armrest with cup holder. Enough thigh and backrest support with wider seating area. All exposed sheet metal parts are powder coated. All fasteners are zinc coated. Usage of anchor- fasteners with high bonding grouting material. Seat sr. Numbering on chair cushion. Chair structure is made In combination of erw pipe & sheet metal. Back/cushion is made up of polyurethane foam {P.U.} with density of 50±5 kg/m. Side light arrangement on aisle seats for easy traceability of rows/seats. Cloth 60" W-1.55 Mtr.	P.O.R



Sr. No.	Product Detail	Specification	Price
227	Cine Deluxe Without Head Rest	Centre to centre distance 560mm. Size: Height: 900mm, Seat Height: 470mm, Depth: 750mm (Normal), After Push back 925mm & Width: 560mm. Push back reclining without Headrest. Auto tip up cushion. Seat sizes available from CTC 21" to 24" PP injection moulded cushion and back cover. Cushion housing with acoustical perforation Armrest with integral cup-holder duly injection moulded and with an integral skinned PU Form moulded OR fabric upholstered PU form insert at hand resting portion.	P.O.R



	COF-227	Pushback with auto tip up feature. PPCP injection moulded housing for cushion & backrest. Moulded flame resistant & CFC free PU foam. Integral skin moulded armrest with cup holder. Enough thigh and backrest support with wider seating area. All exposed sheet metal parts are powder coated. All fasteners are zinc coated. Usage of anchor-fasteners with high bonding grouting material. Seat sr. Numbering on chair cushion. Chair structure is made In combination of erw pipe & sheet metal. Back/cushion is made up of polyurethane foam (P.U.) with density of 50±5 kg/m. Side light arrangement on aisle seats for easy traceability of rows/seats. Cloth 60" W-1.50 Mtr.	
--	---------	------------------------------------------------------------------------------------------------------------------------------------------------------------------------------------------------------------------------------------------------------------------------------------------------------------------------------------------------------------------------------------------------------------------------------------------------------------------------------------------------------------------------------------------------------------------------------------------------------------------------------------------------------------------------------------------	--

Sr. No.	Product Detail	Specification	Price
228	900 Chair COF-228	Centre to centre distance 595mm. Seat & Back: Finish with Internal structure in tubular steel. Padding in moulded polyurethane foam. Synchronized tip- up mechanism for seat & back .Side Arm with internal structure in pressed sheet metal and PPCP panels Covering the structure. & panel covering with fabric or Leather. Side available also with writing tablet in Medium Density PVC finish, scratches proof folding in the side, with anti panic movement. Note: Floor must be minimum 100mm thick RCC slab to grout the chairs or otherwise written confirmation on deviation should be taken by Bonton, as regard to floor. Steps depth must be as per layout – deviations must be discussed with Bonton and written consent of Bonton is must in this regard before placing the order.	P.O.R



Sr. No.	Product Detail	Specification	Price
229	Sofa 3Seater COF-229	Specification- Size-H-870 mm, L-1940 mm, D-840 mm. Structure made of treated agro wood, fitted With 50mm wide rubberized belts 50mm wide with high density PU foam as per design, Upholstered with premium quality PU cloth with help of stitching, where ever necessary. Tapestry- 06 Mtr. Overall appearance as per photograph.	P.O.R



Sr. No.	Product Detail	Specification	Price
230	Sofa 2 Seated COF-230	Specification- Size-H-870 mm, L-1450 mm, D-840 mm. Structure made of treated agro wood, fitted with 50mm wide rubberized belts 50mm wide with high density PU foam as per design, Upholstered with premium quality PU cloth with help of stitching, where ever necessary. Tapestry – 05 Mtr Overall appearance as per photograph.	P.O.R



Sr. No.	Product Detail	Specification	Price
231	Sofa Signal seated COF-231	Specification- Size-H-870 mm, L-925 mm, D-840 mm. Structure made of treated agro wood, fitted with 50mm wide rubberized belts 50mm wide with high density PU foam as per design, Upholstered with premium quality PU cloth with help of stitching, where ever necessary. Tapestry- 04 Mtr Overall appearance as per photograph.	P.O.R



Sr. No.	Product Detail	Specification	Price
232	Sofa 3 Seated straight line COF-232	Specification- Size-H-700 mm, L-1730 mm, D-800 mm. Structure made of treated agro wood, fitted with 50mm wide rubberized belts 50mm wide with high density PU foam as per design, Upholstered with premium quality PU cloth with help of stitching, where ever necessary. Tapestry- Mtr Overall appearance as per photograph.	P.O.R



Sr. No.	Product Detail	Specification	Price
233	Sofa 2 Seated-straight line COF-233	Specification- Size-H-700 mm, L-1290 mm, D-800 mm. Structure made of treated agro wood, fitted with 50mm wide rubberized belts 50mm wide with high density PU foam as per design, Upholstered with premium quality PU cloth with help of stitching, where ever necessary. Tapestry- Mtr Overall appearance as per photograph.	P.O.R



Sr. No.	Product Detail	Specification	Price
234	Sofa 1 Seated-straight line COF-234	Specification- Size-H-700 mm, L-735 mm, D-800 mm. Structure made of treated agro wood, fitted with 50mm wide rubberized belts 50mm wide with high density PU foam as per design, Upholstered with premium quality PU cloth with help of stitching, where ever necessary. Tapestry Overall appearance as per photograph.	P.O.R
235	Corner Table COF-235	Size: Length: 600mm, Width: 600mm, Height: 450mm. Under Structure made of MS cold rolled close annealed tube 1.2 mm thick, duly powder coated after anti corrosion treatment of surface. Top Made up from 18mm Pre-laminated Particle board/ 12mm clear float glass.	P.O.R
236	Round Table Dia 450 COF-236	Round Dia.450mm. Under Structure made of Chrome plated. Top Made up from 12mm clear float glass.	P.O.R
237	Centre Table COF-237	Size: Length: 900mm, Width: 600mm, Height: 450mm. Under Structure made of MS cold rolled close annealed tube 1.2 mm thick, duly powder coated after anti corrosion treatment of surface. Top Made up from 18mm Pre-laminated Particle board/ 12mm clear float glass.	P.O.R
238	Wooden Corner Table COF-238	Overall Size: 600 x 600 x 480mm Legs shall made out of 62x62mm teakwood section as per photo graph. Top rail shall be mad e of 62x22mm as per photo graph. Top shall be made of 18mm veneer faced MDF board. Teak wood beading of 18mm shall be fitted as per approval. Polish- PU-polish shall be done. The overall appearance of the product shall be as per photograph.	P.O.R
239	Wooden Centre Table COF-239	Overall Size: 1200 x 600 x 450 mm Legs shall made out of 7 5 x7 5 mm teal rood section as per photograph. Top rail shall be ma de of 7 0x22mm as per photograph. Top shall be made of 18mm veneer faced MDF board. Teak wood beading of 18mm shall be fitted as per approval. Polish- PUpolish shall be done. The overall appearance of the product shall be as per photograph	P.O.R
240	Reception Convex Table COF-240	Size: Convex Table : - 1 500 (W) x 805 (D) x 750 (H) mm (60 degree convex).The tops of the counters shall be made of toughened glass & shallthe counter with good quality fittings. Fitted on sides of .The front metal sheet above the top shall fitted with the glass & sides so as to make one unit & shall be very sturdy in constructions. Both the front panels, top and bottom, of the counters shall be made of perforated Prime CR sheet of thickness 0.7 mm. The worktops shall be made of 25mm thick BSL particle board and side shall be of 18 mm thick BSL particle board. The worktops shall have 2 cable managers on both sides. The toughened glass shall be of 8 mm thickness. The overall appearance of the product shall be as per photograph.	P.O.R



Sr. No.	Product Detail	Specification	Price
241	Reception Convex Counter Riser COF-241	Size : Counter Riser: - I 500 (W) x 461(D) x 350 (H) mm (60 degree convex)	P.O.R
242	Reception Straight Table COF-242	Size : Straight Table: - 1400 (W) x 700 (D) x 750 (H) mm (180 degree convex) The tops of the counters shall be made of toughened glass & shall the counter with good quality fittings. Fitted on sides of .The front metal sheet above the top shall fitted with the glass & sides so as to make one unit & shall be very sturdy in constructions. Both the front panels, top and bottom, of the counters shall be made of perforated Prime CR sheet of thickness 0.7 mm. The worktops shall be made of 25mm thick BSL particle board and side shall be of 18 mm thick BSL particle board. The worktops shall have 2 cable managers on both sides. The toughened glass shall be of 8 mm thickness. The overall appearance of the product shall be as per photograph.	P.O.R
243	Reception Straight Counter Riser COF-243	Size : Extension Top: - I400(W) x 300 (D) x 350 (H) mm (180 degree convex)	P.O.R
244	CFTR-1200 COF-244	BT-CFTR-1200, Size: - Dia. 1200mm, H-750 thick and glass top of 12mm thick. Top made of 18mm thick rubber wooded top, levelers at bottom. OR Frame made of 1.2 mm thk M.S. cold rolled close annealed tube Chrome plated. Fitted with 18mm rubber top or Glass Top - 12mm thick.	P.O.R
245	CFTR- 1200x600 COF-245	Size: Width: 1200mm, Width: 600mm, Height: 750mm. 4 seater. Top made of 18mm thick rubber wooded top, 4 levelers at bottom. OR Frame made of 1.2 mm thk M.S. cold rolled close annealed tube Chrome plated. Fitted with 18mm rubber top or Glass Top – 12mm thick. The Under structure of table is made Up of SS 202 tube of 1.25mm thick	P.O.R
246	Cafeteria Table without chair COF-246	Cafeteria table without chair Dia 900mm, Height-750mm, Top made of 18mm thick granite top, levelers at bottom. OR Frame made of 1.2 mm thk M.S. cold rolled close annealed tube Chrome plated. Fitted with 18mm granite top or Glass Top – 12mm thick.	P.O.R
247	Cafeteria Table without chair COF-247	Cafeteria table without chair Dia 900mm, Height-1050mm, Top made of 18mm thick rubber wooded top, levelers at bottom. OR Frame made of 1.2 mm thk M.S. cold rolled close annealed tube Chrome plated. Fitted with 18mm rubber top or Glass Top – 12mm thick.	P.O.R
248	Single Bed COF-248	BT-Single Bed Overall Size- 960 x 2000 x 900 With out storage Made in 18 mm thick prelamated particle board structure MS 3/4" square pipe frame power coated, with head rest.	P.O.R

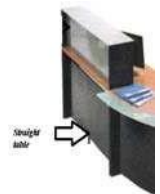

Sr. No.	Product Detail	Specification	Price
249	Double Bed COF-249	BT-Double Bed Over all Size 1560 x 2000 x 900 With out Storage Made in 18 mm thick prelaminated particle board structure MS 3/4" square pipe frame power coated, with head rest.	P.O.R



Sr. No.	Product Detail	Specification	Price
250	Bed Side Table COF-250	Bed Side Table Overall Size- 600mm x 450mm x 450 mm (One Drawer) Made in 18 mm thick prelaminated particle board, with single drawer with Open rack.	P.O.R



Sr. No.	Product Detail	Specification	Price
251	Single Wardrobe COF-251	Single Wardrobe Overall Size-900mm x 600mm x 1950mm, . Made in 18 mm thick prelaminated particle board, with dressing glass.	P.O.R



Sr. No.	Product Detail	Specification	Price
252	Three Door Wardrobe COF- 252	Three Door Wardrobe Overall Size-1350mm x 600 mmx 1950 mm, Made in 18 mm thick prelaminated particle board	P.O.R



Sr. No.	Product Detail	Specification	Price
253	Dressing COF-253	Dressing Overall Size 600mm x 450mm x1900mm, Made in 18 mm thick prelaminated particle board	P.O.R



OTHER PRODUCT RANGE

LABORATORY EQUIPMENTS



BOROSILICATE LAB GLASSWARE



LAB PLASTICWARE



Visit: www.compositelabline.com

Email: care.compositelab@gmail.com - Phone: #0120-4968617 #0522-4068342, Mobile: 9335902421

Corporate Office :
COMPOSITE LAB LINE PVT LTD

UGSR-1,
Ansal Plaza, Vaishali
Delhi, NCR
Ghaziabad - 201010 (India)
Ph. : 0120-4335636, +919335902421
Mail : care.compositelab@gmail.com
www.compositelabline.com

Lucknow Office :

A-1, OKKP Complex, Near I.T.Crosing
Faizabad Road, Babujanj
Lucknow - 226020 (India)
Ph. : +919580613355 Mail : clpl.lko@gmail.com



Authorised Dealer:

